

**ABERDEEN CITY COUNCIL SMR ENHANCEMENT
PERSLEY BRIDGE TO GRANDHOLM BRIDGE, SOUTH SIDE OF THE
RIVER DON**



**Alison Cameron
Cameron Archaeology
May 2014**

CONTENTS

STRUCTURE 1.....	7
STRUCTURE 2.....	11
STRUCTURE 3.....	11
STRUCTURES 4 AND 5.....	15
STRUCTURE 6.....	16
STRUCTURE 7.....	25
STRUCTURE 8.....	27
STRUCTURE 9.....	28
STRUCTURE 10.....	31
STRUCTURE 11.....	31
STRUCTURE 12.....	35
STRUCTURE 13.....	36
STRUCTURE 14.....	37
STRUCTURE 15.....	39
STRUCTURE 16.....	42
STRUCTURE 17.....	46
STRUCTURE 18.....	48
STRUCTURE 19.....	49
STRUCTURE 20.....	53
STRUCTURE 21.....	53
STRUCTURE 22.....	53
STRUCTURE 23.....	54
STRUCTURE 24.....	55
STRUCTURE 25.....	55
STRUCTURE 26.....	55
STRUCTURE 27.....	57
STRUCTURE 28.....	59
STRUCTURE 29.....	61
STRUCTURE 30.....	61
STRUCTURE 31.....	62
STRUCTURE 32.....	63
STRUCTURE 33.....	64

STRUCTURE 34	65
STRUCTURE 35	66
STRUCTURE 36	67
STRUCTURE 37	68
STRUCTURE 38	69
STRUCTURE 39	70
STRUCTURE 40	70
STRUCTURE 41	71
STRUCTURE 42	73
STRUCTURE 43	74
STRUCTURE 44	74
STRUCTURE 45	74
STRUCTURE 46	75
STRUCTURE 47	76
REFERENCES	79

ILLUSTRATIONS

Cover top: Lade S6 with bridge and culvert S14 (centre top); bottom: interior north wall Structure 16 showing infilled upper window and door with added loophole.

Illus 1 First Edition OS map	6
Illus 2 Plan of Woodside Mill features	7
Illus 3 Structure 1 plan and elevation of north wall (bottom)	8
Illus 4 Structure 1 showing sections of convex curving wall between buttresses; facing S	8
Illus 5 Structure 1 showing sections of convex curving wall between buttresses; facing ENE.....	9
Illus 6 Detail of First Edition OS map showing water tank Structure 1	9
Illus 7 Structure 1 south (inner) face of wall; facing N.....	10
Illus 8 Structure 2 with Structure 3 in background; facing N	11
Illus 9 Plan of Structure 3	12
Illus 10 Structure 3; facing NW	12
Illus 11 Elevations of Structure 3 facades	13
Illus 12 West gable of Structure 3, originally an interior wall prior to demolition	13
Illus 13 Structure 3 west gable interior face showing blocked door; facing W	14
Illus 14 Structure 3 east gable interior face showing blocked doorway on south side	14
Illus 15 Structure 4; facing N	15
Illus 18 Summary of lades associated with Woodside Mills on First Edition OS map	17
Illus 19 East end Structure 6 with Structure 7, Lade S8 and concrete bridge over Lade S6	17
Illus 20 Facing of north wall of lade S6 at east end showing damage due to established trees	18
Illus 21 North wall of lade S6; the lade has been infilled (foreground)	18
Illus 22 Lade S6 ashlar wall (right) with poorly built wall (centre right) and infilled lade	19
Illus 23 East end lade S6 wall showing stone structure (left) with poured concrete extension.....	19
Illus 24 East end lade S6 wall showing stone steps and stone and brick structure (right)	20

Illus 25 Plan of north wall of Structure 6 (bottom) and elevation of the north face of the structure .	21
Illus 26 North façade of north wall of lade S6 showing one of the inserts of masonry.....	21
Illus 27 Plan of lades north of Woodside House showing location of section and demolished bridge S8	22
Illus 28 Section through Lades S6 and S8.....	22
Illus 29 Lade S6 adjacent to Woodside House (left) partly infilled; facing W.....	23
Illus 30 Lade S6 immediately NW of Woodside House; facing N.....	23
Illus 31 Lade S6 infilled (left) and shallow but still visible (top centre)	24
Illus 32 S6 NE of bridge and sluice S14; facing E	24
Illus 33 S6 SW of bridge and sluice S14; facing SW.....	25
Illus 34 Structure 7 west wall with wall of lade S6 (right); facing E	25
Illus 35 2nd (top) and 3 rd (bottom) Edition OS maps (copyright National Library of Scotland).....	26
Illus 36 East end Lade S8 with vaulted 'bridge' plan and elevation.....	27
Illus 37 West side of brick vaulted 'bridge'; for location see Illus 36.....	27
Illus 38 Lade S8 north of Woodside House; lade S6 runs parallel (top right)	28
Illus 39 Plan of Structure 9	29
Illus 40 Structure 9 (centre) showing original east end complete	29
Illus 41 Structure 9; facing WSW.....	30
Illus 42 Internal SW corner Structure 9; facing SW.....	30
Illus 43 Culvert S10 at outflow into river Don; facing SW	31
Illus 44 Pillared gate into enclosure S11 from SW; facing SW	32
Illus 45 Plan showing Structures 11 and 9	32
Illus 46 Elevations of S13/S33 and S36 (for location of elevations see Illus 45).....	33
Illus 47 Plan of south half of enclosure S11 with elevation showing surviving buttresses.....	33
Illus 48 Buttresses on the interior of the south wall of enclosure S11	34
Illus 49 Buttress on the interior of the south wall of enclosure S11 showing damage from trees	34
Illus 50 Structure 12 showing concrete partitions in older granite building	35
Illus 51 Lade S13 from bridge S33; facing WSW	36
Illus 52 Lades and sluices adjacent to Persley Castle.....	37
Illus 53 Elevations of S14 and plan (right) showing elevation locations.....	37
Illus 54 Sluice gate mechanisms on the west side of the bridge	38
Illus 55 Sluice gate structure on the west side of the bridge marked 'A Pirie & Sons 1919'	38
Illus 56 Bridge S15 over Lade S6; facing SW	39
Illus 57 Lade S15 stonework under Core Path 7 with culvert (top); facing WSW.....	40
Illus 58 Lade S15 (left) and S6 (right) north of Persley Castle; facing E	40
Illus 59 Outflow of lade S15 at junction with river Don; facing NE.....	41
Illus 60 Earlier lade S15 blocked by north wall lade S6; facing ENE.....	41
Illus 61 Plan of Structure 16.....	42
Illus 62 Structure 16 elevations of exterior walls.....	43
Illus 63 Building S16 (right), track and remains of boundary wall S20 (right); facing W	43
Illus 64 Structure 16 south façade; facing NW.....	44
Illus 65 Structure 16 interior of north wall showing blocked window (above) and door (below).....	44
Illus 66 Structure 16 West wall showing arched window formed using granite blocks; facing E.....	45
Illus 67 Structure 16 east wall showing structure built into the slope and the narrow path	45
Illus 68 Structure 16 from north side of river Don showing elevated position above river; facing SW	46
Illus 69 Structure 17 plan (left) showing entrance and relationship to walls S20 and S21	46

Illus 70 Structure 17 interior facing walled garden; facing S	47
Illus 71 Wall S21 with wall of S17 (left of ranging rod) showing poor condition of walls and overgrown and infilled structure with remains of entrance (left of centre).....	47
Illus 72 Joist holes from demolished building on exterior of north wall of walled garden S19.....	48
Illus 73 Elevations of walled garden with plan (not to scale) showing locations	48
Illus 74 Walled garden S19 showing thicker wall on north half of garden	49
Illus 75 Plan of walled garden, Structures S16, 17 and 18.....	50
Illus 76 Gate in north wall walled garden S19 with wall S21 in background; facing N	50
Illus 77 Section of north wall walled garden S19 showing interior (right) lined with brick; facing E ...	51
Illus 78 Walled garden D19 showing thicker north section of east wall and thinner south section	51
Illus 79 Former door converted to window in centre of east wall; facing W	52
Illus 80 The modern entrance on the SE of the garden showing older wall line (right)	52
Illus 81 Walled garden and surrounding features on First Edition OS map.....	53
Illus 82 Poured concrete bridge taking footpath over remains of Lade 6; facing NNE.....	54
Illus 83 South façade Persley Castle; facing N.....	54
Illus 84 South façade (right) of Woodside House; facing NE	55
Illus 85 Remains of sluice S26 with river Don (right) and lade S6 (left); facing S.....	56
Illus 86 Sluice 26 from north bank of river Don; facing ENE	56
Illus 87 Sluice S27 with lade S6 (left), concrete sluice (centre, boundary wall (centre) and Structure 46 Persley Bridge (top right); facing SW	57
Illus 88 Sluice S27 from the north side of the river showing overgrown sluice mechanism	58
Illus 89 S27 sluice mechanism; facing E	58
Illus 90 Plan and elevation of poured concrete bridge S28	59
Illus 91 The bridge S28 facing west.....	60
Illus 92 Bridge S20 poured concrete pier on the west side of the bridge.....	60
Illus 93 Bridge S28 with steel beam marked 'LANARKSHIRE STEEL CO LTD SCOTLAND 7 x 4'	61
Illus 94 Stone embankment S30 with river Don (left), Lade S6 (right) and Persley Castle (top).	62
Illus 95 Weir S31 with Persley Bridge (top left); facing SW	62
Illus 96 Remains of channel S32 outflow into river Don (top); facing ENE	63
Illus 97 Remains of stone wall on south side of channel S32 outflow into river Don; facing S	63
Illus 98 North face of culvert and bridge S33 for lade S13; facing SSW.....	64
Illus 99 South face and east pier of culvert S33 with bridge above showing brick vaulting.....	64
Illus 100 Culvert S10 (right) and S33 (left) with S34 between from north bank of river Don	65
Illus 101 Stone embankment S34 (centre) with culvert S10 (right).....	65
Illus 102 Plan showing S35 (centre) on First Edition OS map showing infilled lade to the west.....	66
Illus 103 Stone and concrete embankment at the junction of outflow of Lades 6 and 8	66
Illus 104 Culvert S36 showing stone vaulting with bridge and culvert S33 (right); facing NW.....	67
Illus 105 Culvert S36 showing stone vaulting on stone foundation; facing NW	67
Illus 106 Plan (left) and elevation (right) of 'seat' S37	68
Illus 107 Entrance to Structure 37; facing W	68
Illus 108 Rear (west side) of structure 37 showing damage due to tree	69
Illus 109 Structure 38 hollow way through mound S40; facing S	69
Illus 110 Stone revetment S39 on south side of mound S40; facing NE.....	70
Illus 111 Mound, probably natural with stone and rubble dumped on south side; facing NE.....	70
Illus 112 Pillbox Structure 41 north-facing elevation with blocked embrasure	71
Illus 113 Pillbox Structure 41 south facing external wall showing central door.....	72

Illus 114 Pillbox Structure 41 plan of pillbox and elevations	73
Illus 115 Two narrow brick walls on exterior of west wall of enclosure S11; facing W	74
Illus 116 ABD 49 March Stone (Copyright Abeer Eladany; photographed 2013)	75
Illus 117 Persley Bridge; facing W	76
Illus 118 Grandholm foot bridge; facing E	76
Illus 119 Roy Military Survey of Scotland 1747-55 showing 'copper mill'	77
Illus 120 Robert Gordon c1636-52 showing Gordons Mill (copyright National Library of Scotland) ...	77
Illus 121 Blaeu 1654 showing Gordon's Mills to the east and The Cruvis to the west	78
Illus 122 Gibb 1858 showing Woodside Works and [Woodside] House	78
Illus 123 1973 aerial photograph showing sand and gravel workings	79

INTRODUCTION

This survey was commissioned by Judith Stones, Aberdeen City Council as Sites and Monuments Record enhancement. All numbers referred to are Aberdeen City Council SMR numbers. A conversion chart is available in Appendix 2. The measured survey was carried out in conjunction with the OS maps; plans of superimposed features appear in this report (see Illus 1, 2). The First, Second and Third Edition OS maps were examined and several buildings were identified from the maps which are no long extant; see archive for details.



Illus 1 First Edition OS map Aberdeen Sheet LXXV.2 (Combined) Survey date: 1867 Publication date: 1869 (copyright National Library of Scotland)

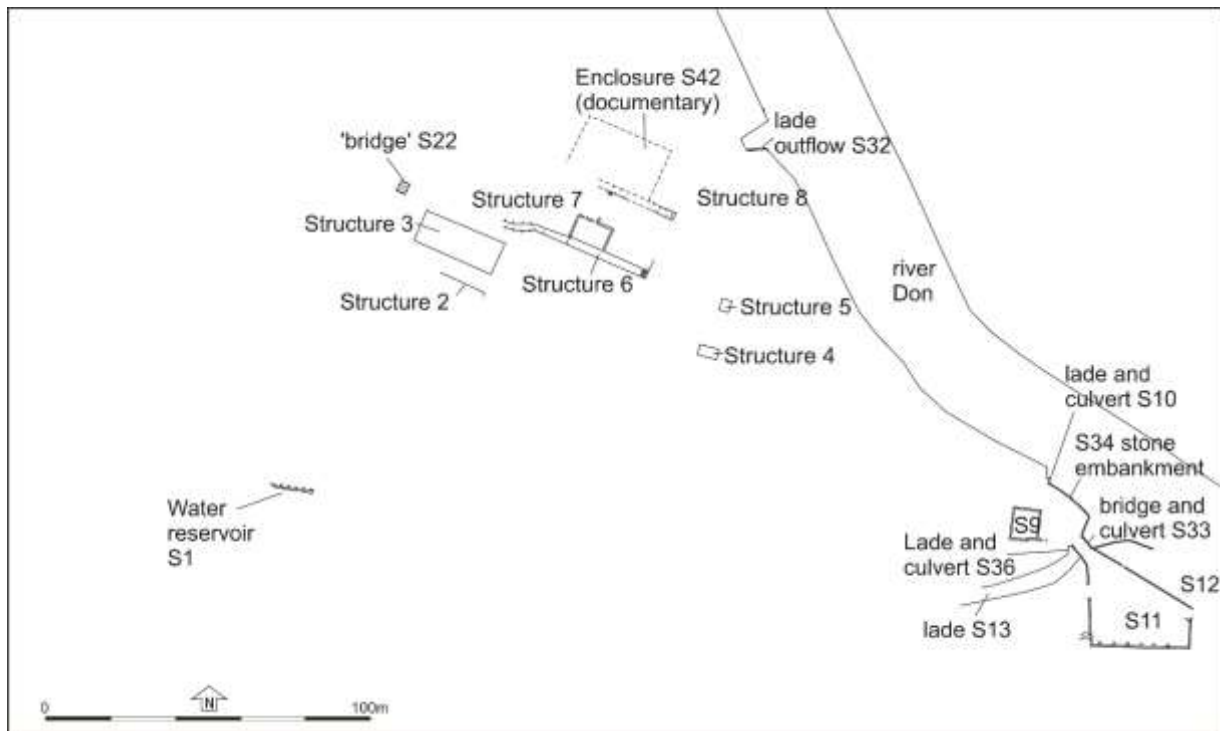

Illus 2 Plan of Woodside Mill features

All the historical information was supplied from Aberdeen City Council Sites and Monuments Record (Judith Stones and Dr C Croly), from Pastmap and CANMORE (RCAHMS).

There are no Scheduled Ancient Monuments within the area of this study. There are four Listed Buildings including Woodside House, Persley Castle, March Stone 49 and Persley Bridge.

Several buildings have been identified from maps but are no longer visible. These include a copper mill (Illus 116 Roy Military Survey of Scotland 1747-55) in the mid 18th century in the area below and to the north of Persley Castle. Many of the Woodside Mill buildings are no longer extant; only the standing buildings have been recorded in this survey.

STRUCTURE 1

Structure 1 is the remains of a water tank. It is 20.6m long (W-E) and the north wall survives with the remainder of the structure as an earthwork (Illus 3). The north wall consists of exterior buttresses 1m wide and a maximum of 1.84m high constructed of large granite blocks with cherry cocking (Illus 4). Between the buttresses section of convex curved wall sections c0.6m wide and up to 1.5m deep with large and medium stone blocks and cherry cocking on the north face (Illus 4) with traces of mortar; the south (inner) face of the wall is constructed of overlapping medium-sized granite blocks with no evidence of mortaring (Illus 7). This may have become eroded or there may have been no requirement for bonding in the inner face. An aperture has been created between two of the buttresses but the wall would have continued as an unbroken structure when it was first built.

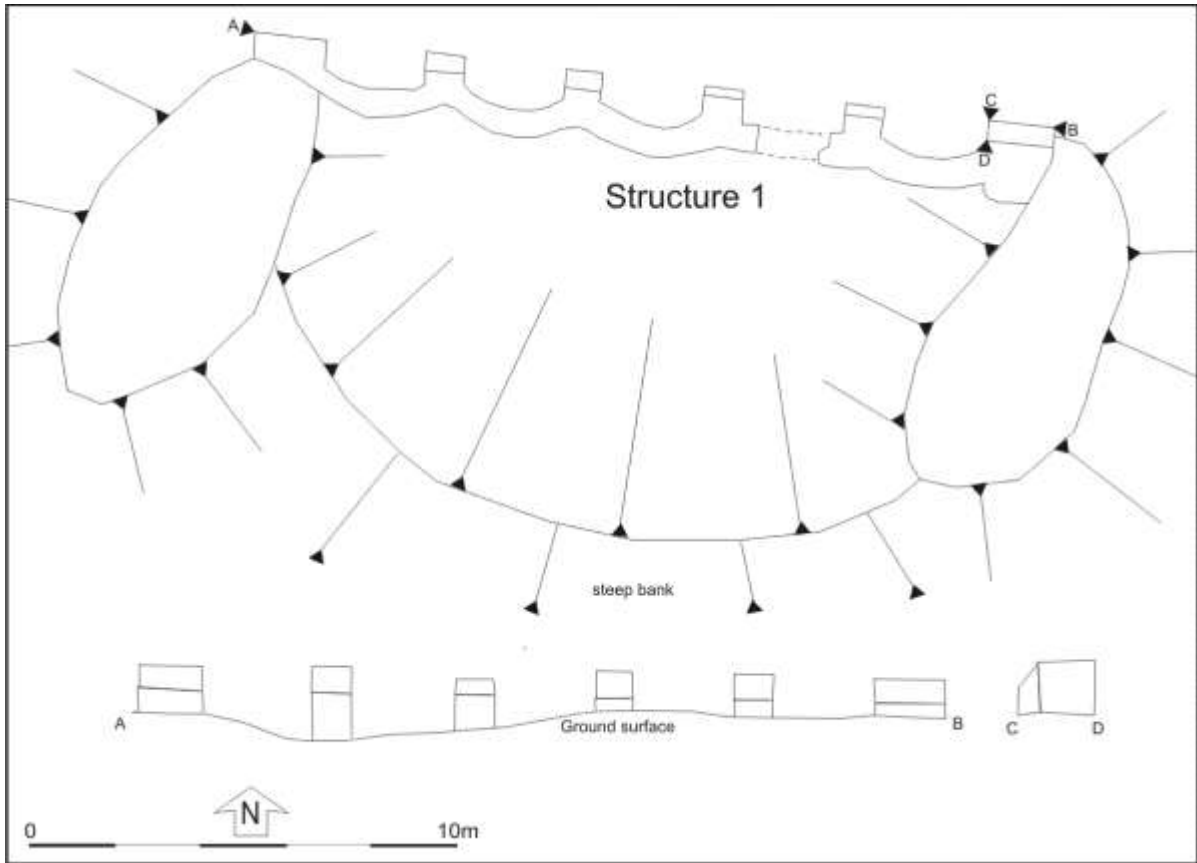

Illus 3 Structure 1 plan and elevation of north wall (bottom)



Illus 4 Structure 1 showing sections of convex curving wall between buttresses; facing S



Illus 5 Structure 1 showing sections of convex curving wall between buttresses; facing ENE

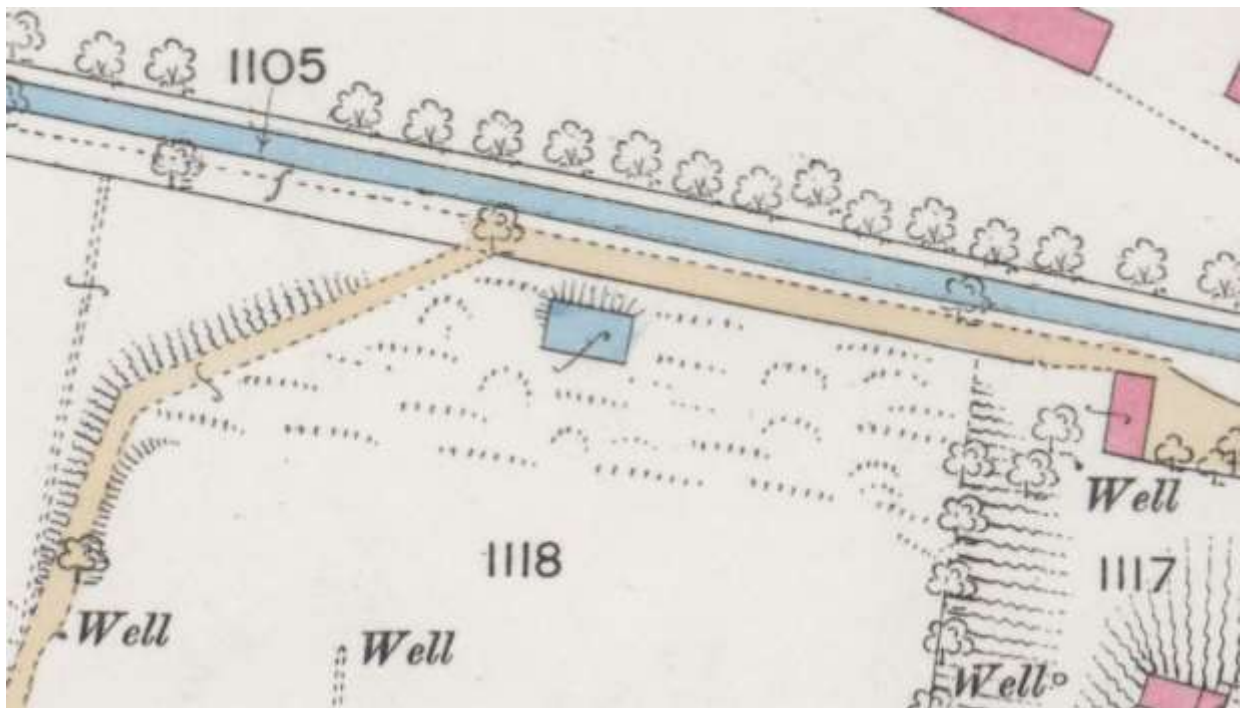

Illus 6 Detail of First Edition OS map showing water tank Structure 1 (centre) (copyright National Library of Scotland)



Illus 7 Structure 1 south (inner) face of wall; facing N

STRUCTURE 2

Structure 2 (Illus 8) is a 19.33m section of small and medium-sized granite rubble wall curved at the SE end. It is 0.39m thick at the east end and 0.48m. This wall is the remains of an enclosure between two buildings which have been demolished (Illus 1)



Illus 8 Structure 2 with Structure 3 in background; facing N

STRUCTURE 3

Structure 3 is 30.9m long and 10m wide (Illus 9) and constructed of granite rubble with roughly trimmed granite block quoins. When the mill was in production this building stood on the south side of Lade S6. The main entrance is now at the east end where a modern door has been installed; the interior of the east wall has at least one blocked aperture (Illus 14) and the north end of the east wall originally had an extension of which there is now no evidence. The upper east gable has been infilled with brick above the modern door. There is a blocked entrance in the west end (Illus 10, 12, 13) and up to 6m of the west end of the building has been demolished (Illus 12) leaving a wall scar at the north end of the west wall (Illus 10). There are a series of blocked upper windows in the north and south walls and smaller windows in the east end of the north wall on the ground floor level (Illus 9). The interior is overgrown with trees and other undergrowth and dumped rubbish.

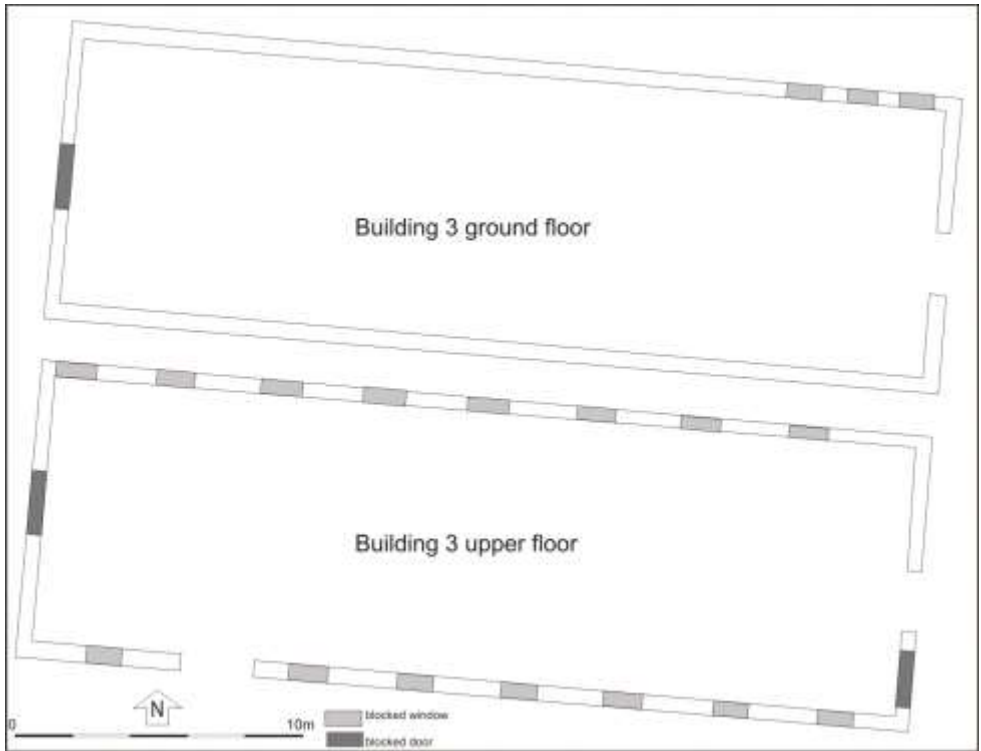

Illus 9 Plan of Structure 3



Illus 10 Structure 3; facing NW

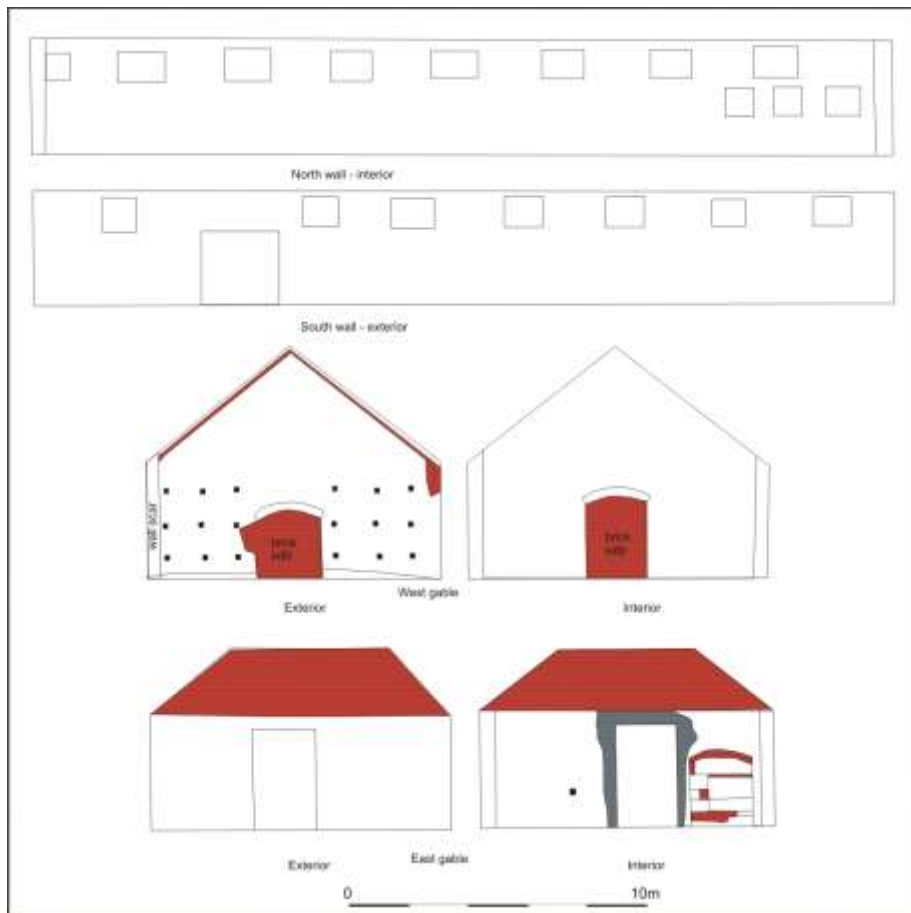

Illus 11 Elevations of Structure 3 facades



Illus 12 West gable of Structure 3, originally an interior wall prior to demolition of west end of building; facing E



Illus 13 Structure 3 west gable interior face showing blocked door; facing W



Illus 14 Structure 3 east gable interior face showing blocked doorway on south side of the newer larger central door; facing E

STRUCTURES 4 AND 5

Structures 4 (Illus 15) and 5 (Illus 16) are the remains of two pieces of machinery left when the buildings were demolished. The remains of floor survive underneath. These structures align with buildings added between the 2nd and 3rd OS editions (c 1899-1924; Illus 17).



Illus 15 Structure 4; facing N



Illus 16 Structure 5 with cassies underneath, the remains of a floor; facing N



Illus 17 Third Edition OS map showing newer buildings into which Structures 4 and 5 were constructed; they were left standing after the buildings were demolished (copyright National Library of Scotland)

STRUCTURE 6

Structure 6 is the main lade taking water from the Don north of Persley Walled Garden (Illus 18) at Sluice S6 following the line of the river to north of Woodside House where it split, the north Arm Structure 8 running along the river to the north of the mill. S6 continued south of S8 to the central area of the mill. An offshoot from S6, S25 ran past the water tank S1 but is no longer visible as it was infilled and is under football pitches and the road from the football pitches to the electricity generating station.

The north wall at the east end of lade S6 survives; the wall is faced with large granite blocks (Illus 20, 21). The stone section is 29m long, 2.8m wide and up to 0.2m high. The western section of the north side of this lade survives at a rough stone bank and further west as a grassy bank; the lade kinked slightly to the south to run along the north wall of Structure 3 (Illus 17). A set of steps on the north side of this wall (Illus 19, 24) would have allowed access to the top of the lade; this end of the lade have been altered over time with brick and poured concrete additions around the steps (Illus 23, 25), possibly for repair purposes.

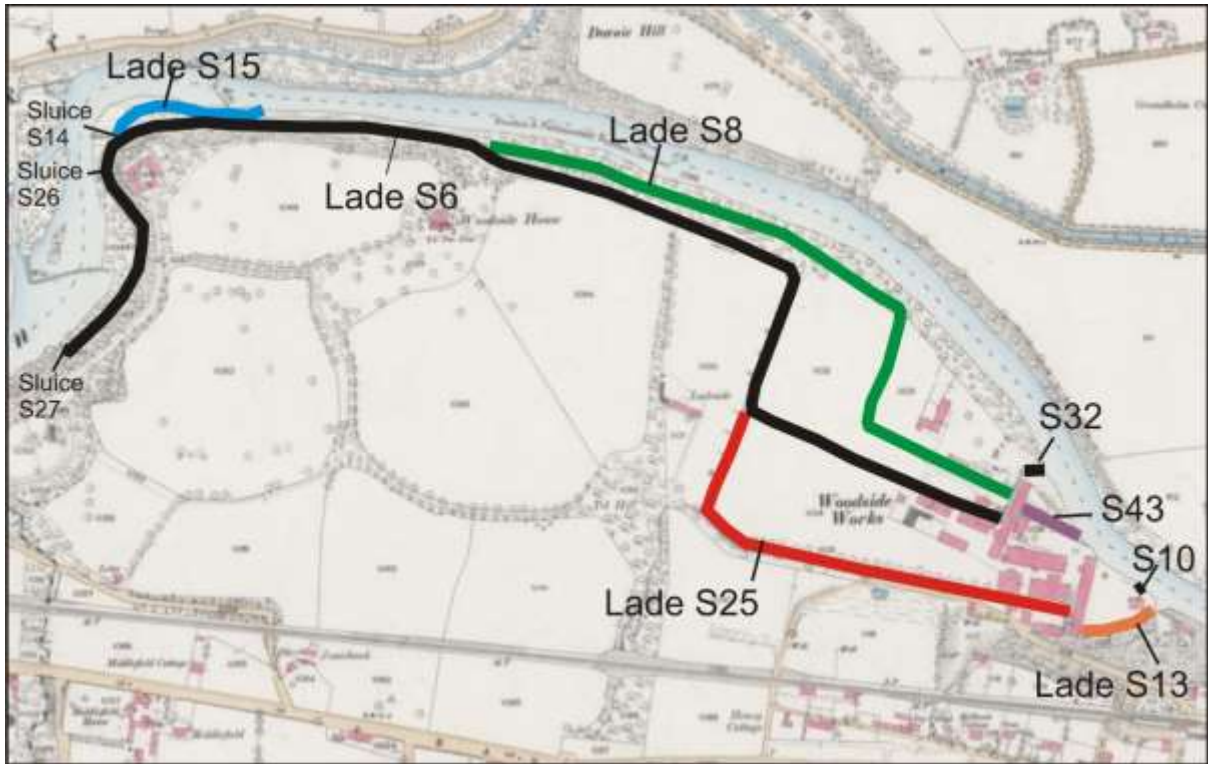

Illus 18 Summary of lades associated with Woodside Mills on First Edition OS map (copyright National Library of Scotland)

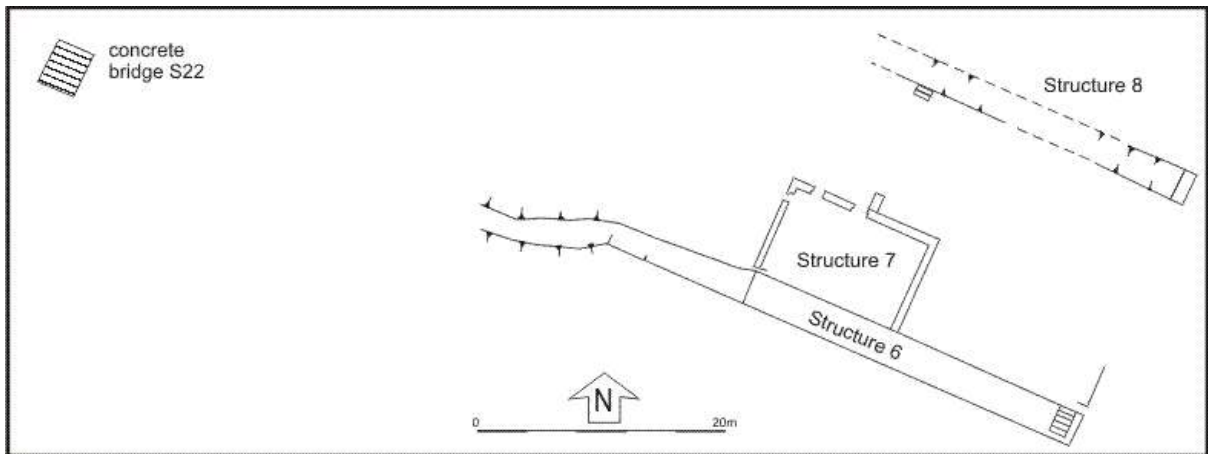

Illus 19 East end Structure 6 with Structure 7, Lade S8 and concrete bridge over Lade S6

A concrete 'bridge' or walkway (S22) was inserted over lade S6 to allow the pedestrian access along the east edge of the football pitches down to the river Don. North of Persley Castle, the construction or rerouting of lade S6 cut off the line of an earlier lade S15 (Illus 18; see S15 below).



Illus 20 Facing of north wall of lade S6 at east end showing damage due to established trees; the line of the lade ran long the foreground of the photograph but has been completely infilled



Illus 21 North wall of lade S6; the lade has been infilled (foreground)



Illus 22 Lade S6 ashlar wall (right) with poorly built wall (centre right) and infilled lade (centre) building S3 (top left); facing W



Illus 23 East end lade S6 wall showing stone structure (left) with poured concrete extension (right); facing W



Illus 24 East end lade S6 wall showing stone steps and stone and brick structure (right) with poured concrete extension (left); facing W

The north face of the north wall of lade S6 (Illus 24, 25) had been rebuilt on several occasions. East of the steps the end had been replaced with shuttered and poured concrete. A repair to the west of the steps was of brick and the whole façade shows that it was originally buttressed or recessed and then infilled with stone infill (Illus 26). The wall was then coped with brick. This wall is being badly damaged by established trees which have been planted on to the top of this structure.

Structure 7 is butted on to the north of this structure.

Lade S6 survives well in sections north and west of Woodside House where it is 2.8m wide and survives to 0.8m deep. North of Persley Castle it is 5m wide and up to 1.8m deep. Its north side is cut into the rock face and the south side is constructed of vertical granite rubble walls (Illus 28-33). The lade is infilled slightly here but the whole structure is being undermined by trees and other vegetation including trees which have fallen in and damaged masonry.

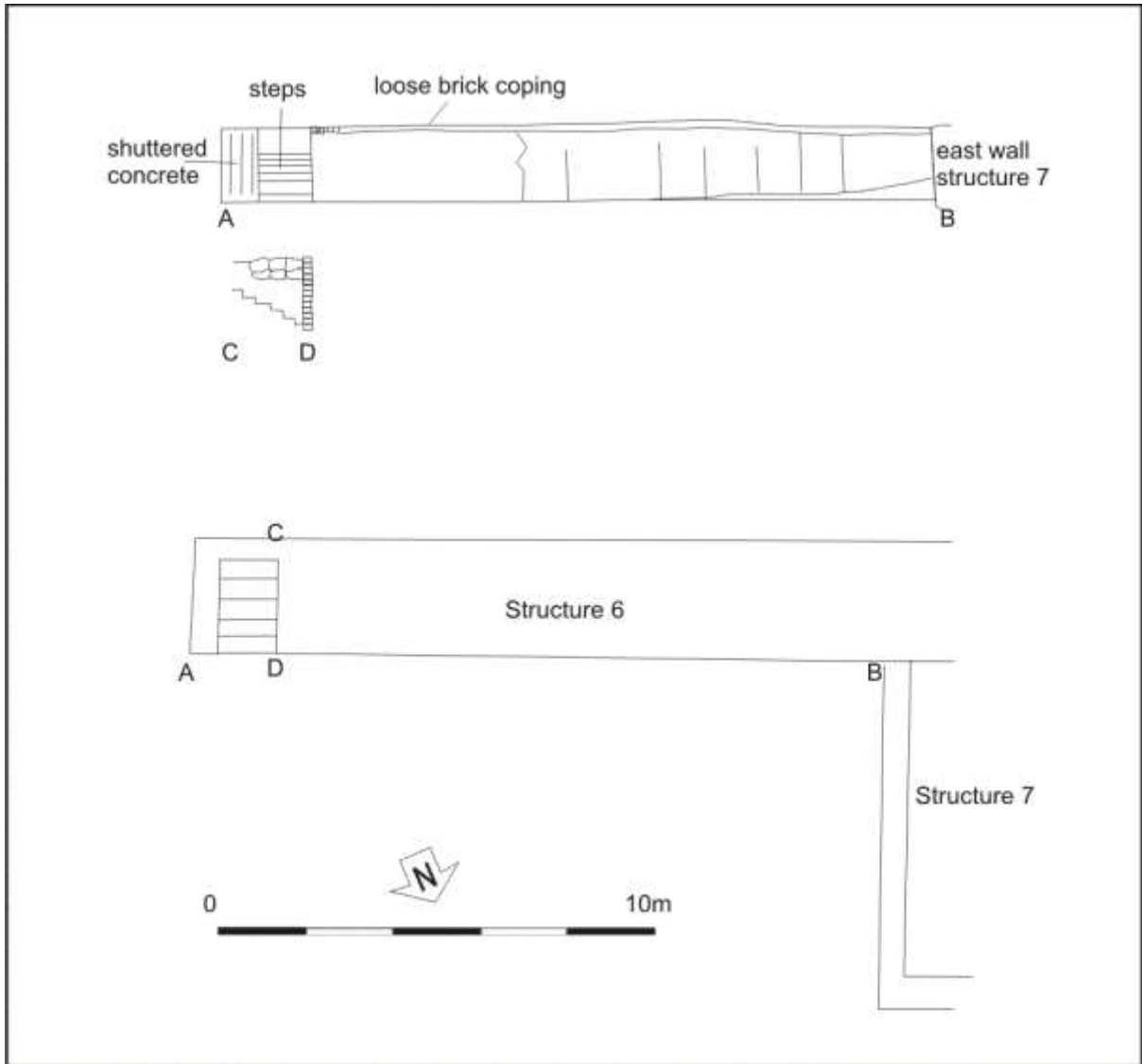

Illus 25 Plan of north wall of Structure 6 (bottom) and elevation of the north face of the structure showing evidence of rebuilding.



Illus 26 North façade of north wall of lade S6 showing one of the inserts of masonry

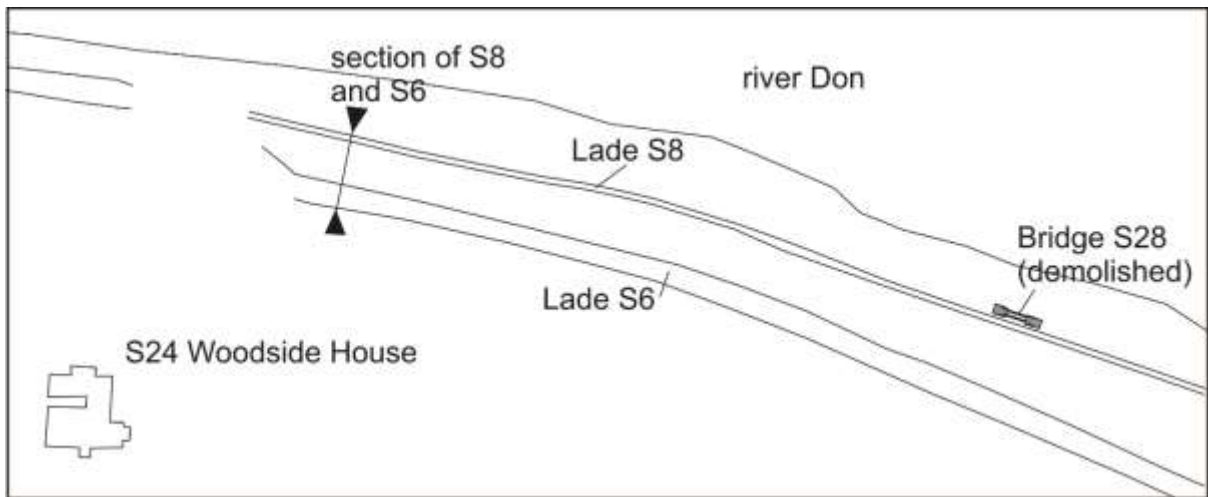

Illus 27 Plan of lades north of Woodside House showing location of section and demolished bridge S8

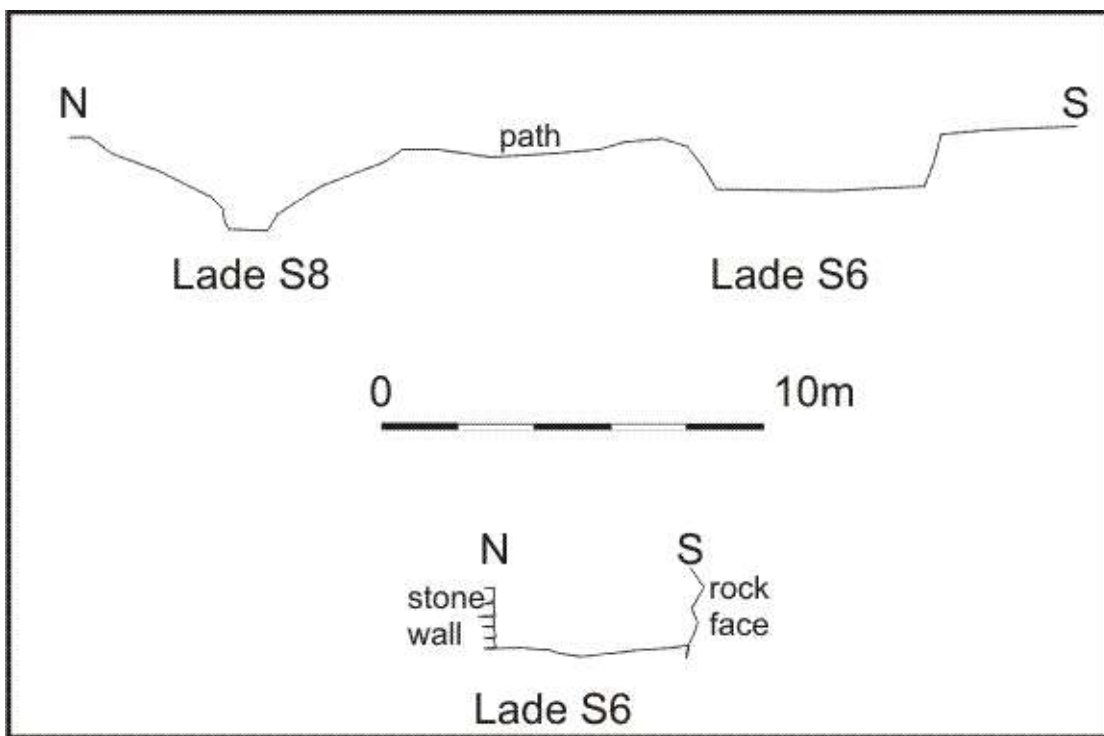

Illus 28 Section through Lades S6 and S8



Illus 29 Lade S6 adjacent to Woodside House (left) partly infilled; facing W



Illus 30 Lade S6 immediately NW of Woodside House; facing N



Illus 31 Lade S6 infilled (left) and shallow but still visible (top centre) in area between Woodside House and Persley Castle; facing WSW



Illus 32 S6 NE of bridge and sluice S14; facing E



Illus 33 S6 SW of bridge and sluice S14; facing SW

STRUCTURE 7

Structure 7 is a building attached to the north wall of Lade S6. The building is 8.10m N-S and 11.9m E-W. The walls are constructed of granite rubble and are 0.63-0.7m wide. There is a door in the north end of the west wall (Illus 34) and one in the north wall and the remains of an extension which is clearly seen on the First and Second Edition OS maps. This building is unroofed by the Third Edition OS (Illus 35).



Illus 34 Structure 7 west wall with wall of lade S6 (right); facing E

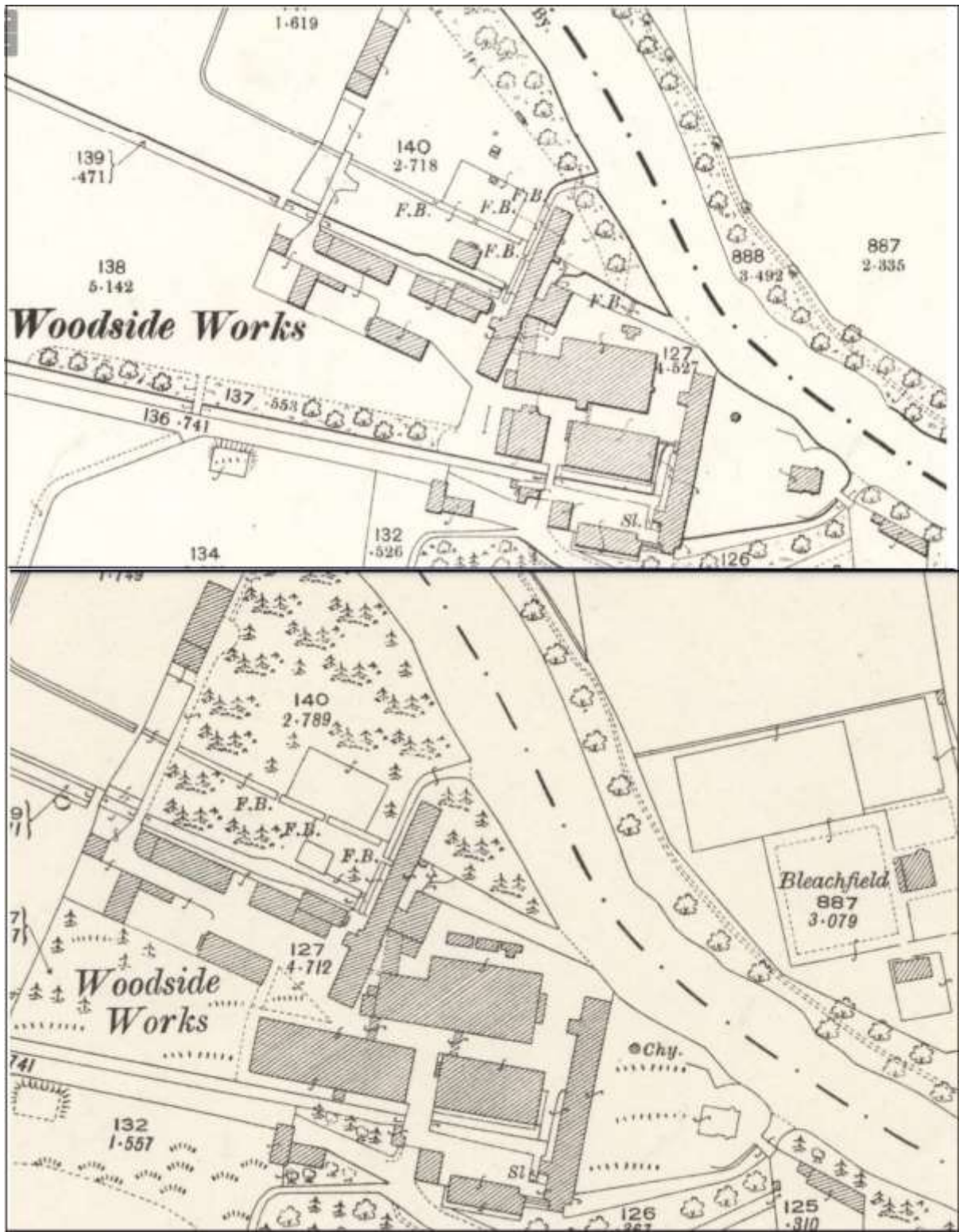

Illus 35 2nd (top) and 3rd (bottom) Edition OS maps (copyright National Library of Scotland)

STRUCTURE 8

Structure 8 (Illus 19) is a lade parallel to and to the north of Lade S6. At the east end animal burrowing has revealed a brick vaulted 'bridge' over the lade (Illus 36, 37). There are at least 28 bricks in the shallow arch and the bricks are 22 x 10 x 7cm in size with the length of the brick used for the thickness of the arch. The lade survives as a shallow trench overgrown with mature trees and undergrowth. It is c 2.6m wide and survives to a depth of c 0.5m. There is some stonework visible at the east end and the remains of a set of steps (Illus 19). There are several footbridges (F.B.) marked on the OS maps of this lade (Illus 35) and these steps align with the location of one of these bridges.

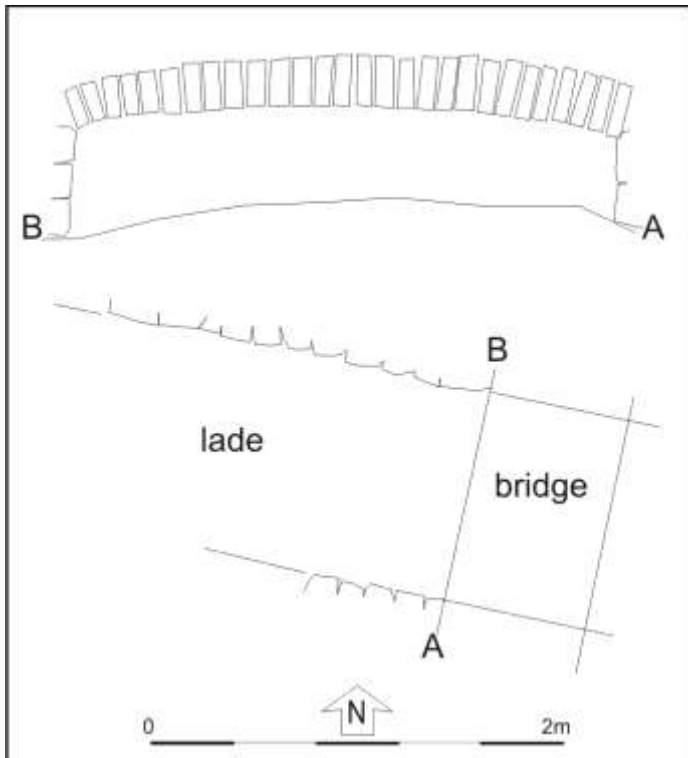

Illus 36 East end Lade S8 with vaulted 'bridge' plan and elevation



Illus 37 West side of brick vaulted 'bridge'; for location see Illus 36

Lade S8 is visible to the NNE of Woodside House where it is V-shaped 4m wide with a squared base 1.2m wide (Illus 28). It is infilled towards the eastern section where it is under the football pitches.



Illus 38 Lade S8 north of Woodside House; lade S6 runs parallel (top right)

STRUCTURE 9

Three courses of the west walls of Structure 8 survive; the east half has been demolished and little trace is visible in the long undergrowth (Illus 39). The west wall is 10.9m long, 0.45m wide and stands to a height of 1m on the exterior and is constructed of granite rubble. The interior is infilled and overgrown. No evidence of the small extensions on the north and west wall (First Edition OS map; Illus 40) can be seen.

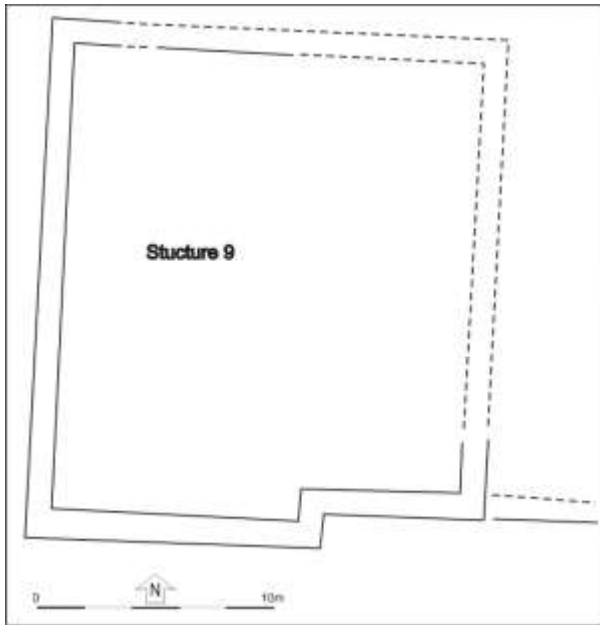

Illus 39 Plan of Structure 9

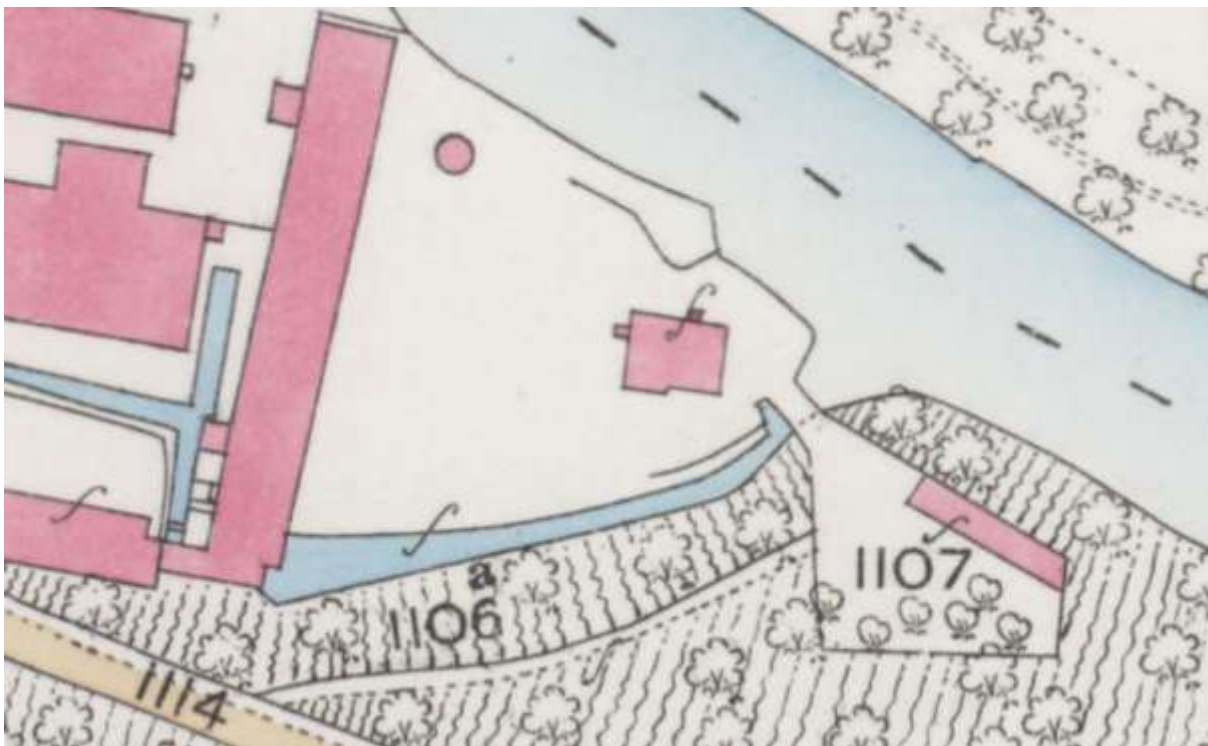

Illus 40 Structure 9 (centre) showing original east end complete and two small extensions on the north and west walls (copyright National Library of Scotland)



Illus 41 Structure 9; facing WSW



Illus 42 Internal SW corner Structure 9; facing SW

STRUCTURE 10

Structure 10 is a brick faced stone vaulted arch outflow for a lade into the river Don. The brick facing is 0.46m thick and contains bricks 21 x 10 x 9cm. The entrance is heavily silted. There is no evidence of the lade which leads to this culvert on the ground but there is a line on the First Edition OS map which might indicate it comes from the mill to the NW.



Illus 43 Culvert S10 at outflow into river Don; facing SW

STRUCTURE 11

Structure 11 is an enclosure at the easternmost extent of the Woodside Mill complex. It is squared to the south and cut into the hill and required buttresses on the interior to support the wall. The wall is 0.52m thick and the enclosure is 32.1m internally E-W. Six buttresses (Illus 47) on the south wall survive, one complete and the other five are incomplete. They have been badly disturbed by trees growing on the hill and into the wall and within the enclosure.

There are two gateways into enclosure S11 one from the NW and one from the SW. Both entrances are flanked by gate pillars (Illus 44) which form impressive entrances into the mill. The enclosure has now been breached on the north side by Core Path 7.



Illus 44 Pillared gate into enclosure S11 from SW; facing SW

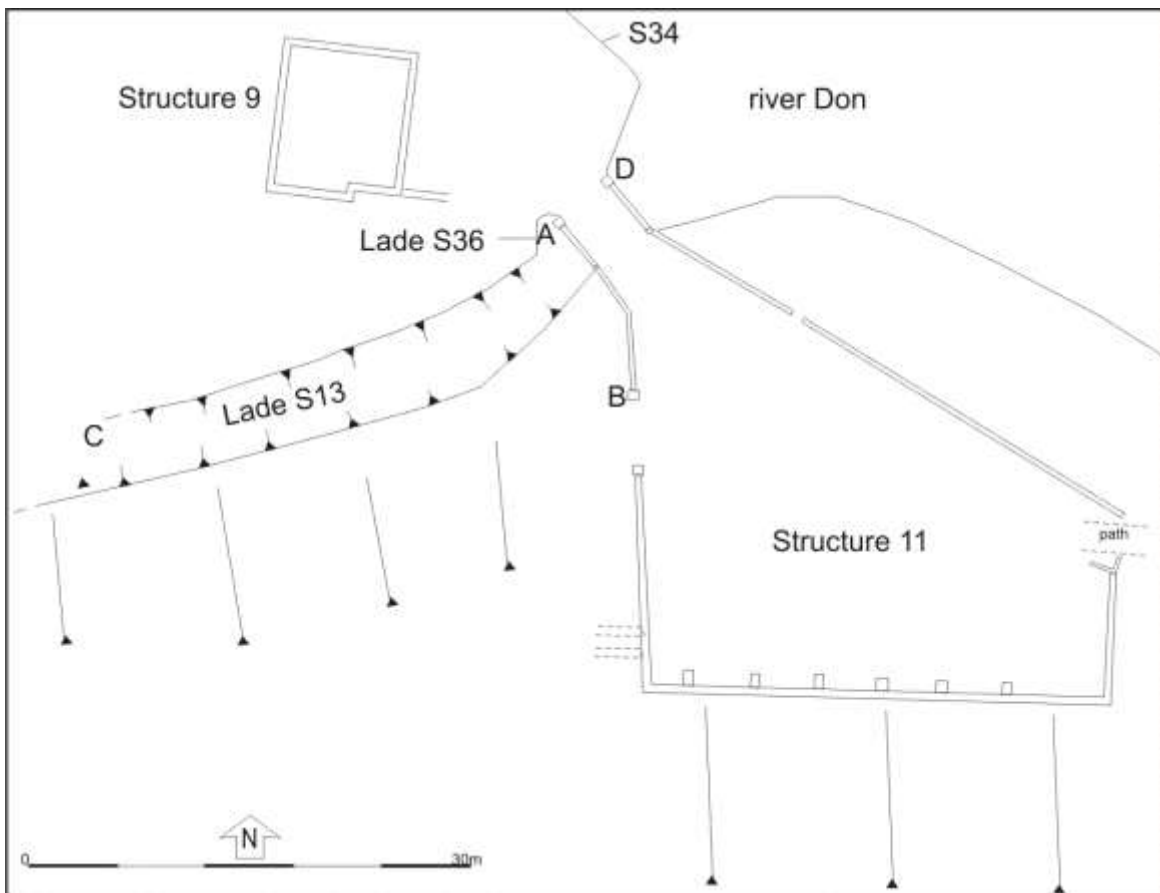

Illus 45 Plan showing Structures 11 and 9

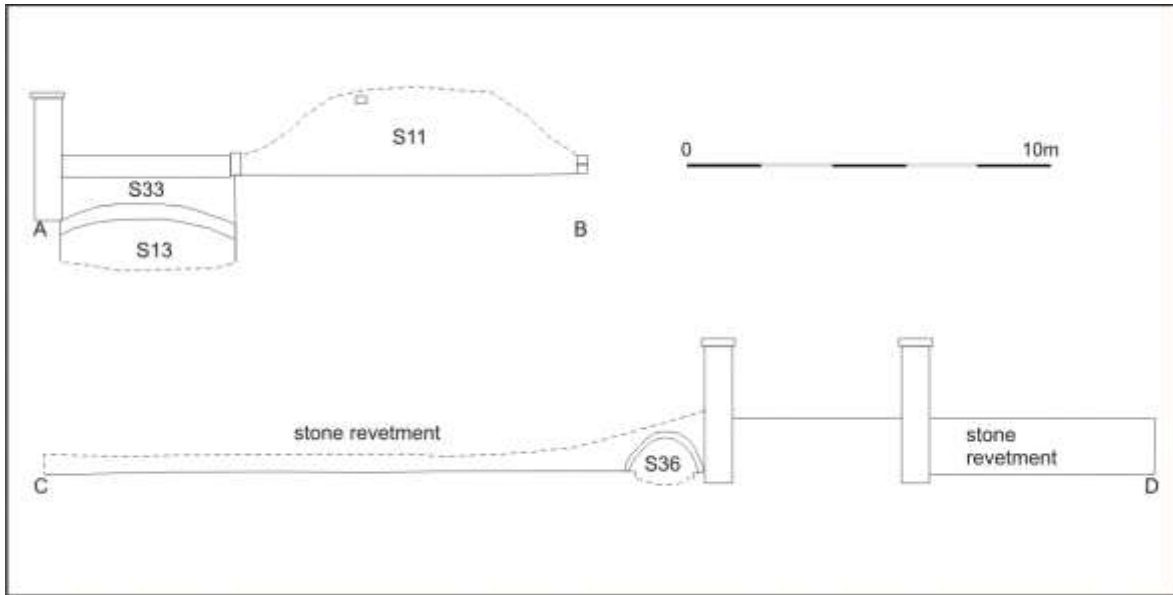

Illus 46 Elevations of S13/S33 and S36 (for location of elevations see Illus 45)

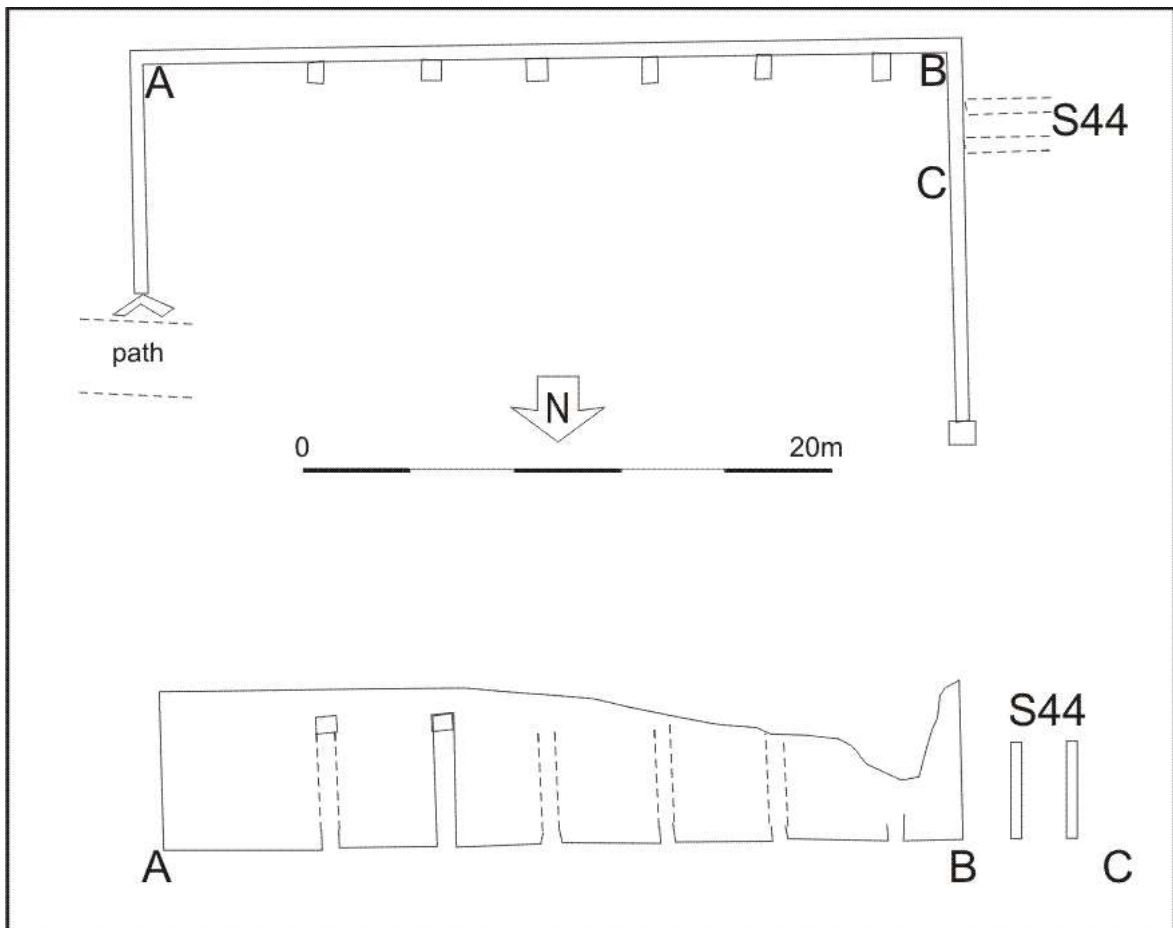

Illus 47 Plan of south half of enclosure S11 with elevation showing surviving buttresses



Illus 48 Buttresses on the interior of the south wall of enclosure S11



Illus 49 Buttress on the interior of the south wall of enclosure S11 showing damage from trees

STRUCTURE 12

Structure 12 was a long narrow building c 20 x 4m in size. It has been modernised in the 20th century when the building was in use as a piggery (Illus 50). Concrete stalls have been inserted and the original walls of the building are mostly obscured.



Illus 50 Structure 12 showing concrete partitions in older granite building

STRUCTURE 13

Lade S13 is at the east of the site and probably took water from lade S25 out to the Don. It was c8m wide at the west end and 3m wide at the east (Illus 51). The north wall of the lade is a stone wall constructed of granite rubble and survives 0.3-0.5m deep along most of its line; the south edge of the lade is overgrown and the edge obscured by material falling down the steep incline on the south side of the lade.



Illus 51 Lade S13 from bridge S33; facing WSW

STRUCTURE 14

Structure 14 is a series of culverts and sluice NNW of Persley Castle (Illus 52). The structure consists of a bridge, culverts and sluice over lade S6 on the south and a smaller culvert to the north over earlier lade S15. The vaulted arches are of granite rubble and worked granite blocks (Illus 56). The sluice gates on the SW façade (Illus 55) were left half open at their last use. They are constructed of a cast iron structure attached to the stone bridge. The sluice is marked 'A Pirie & Sons 1919' and there are marks on the structure to suggest that it came as a kit and was constructed on site. Lade S6 cut through and blocked an earlier lade S15 (see below).

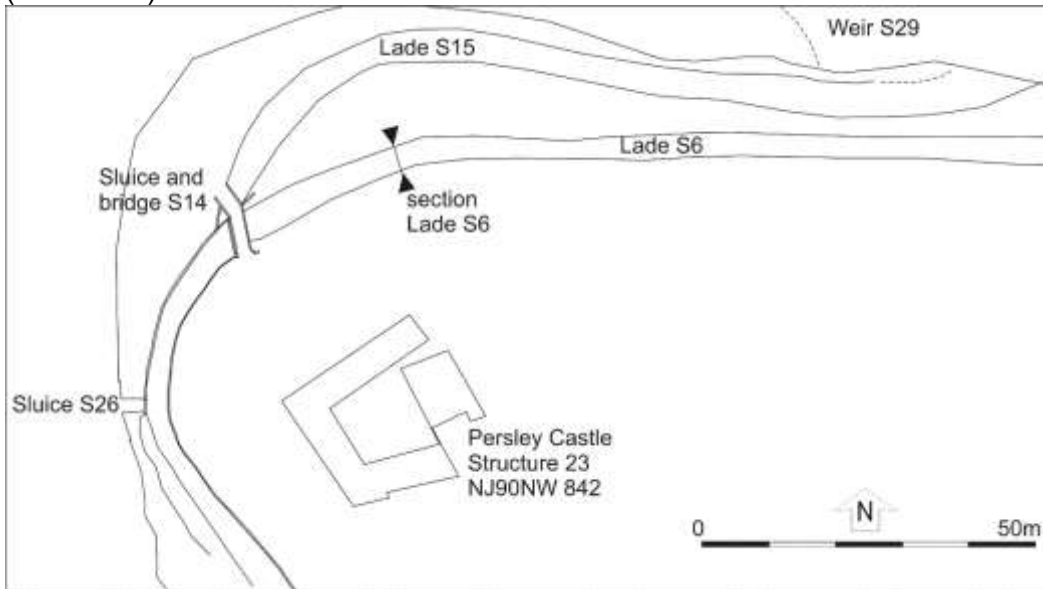

Illus 52 Lades and sluices adjacent to Persley Castle

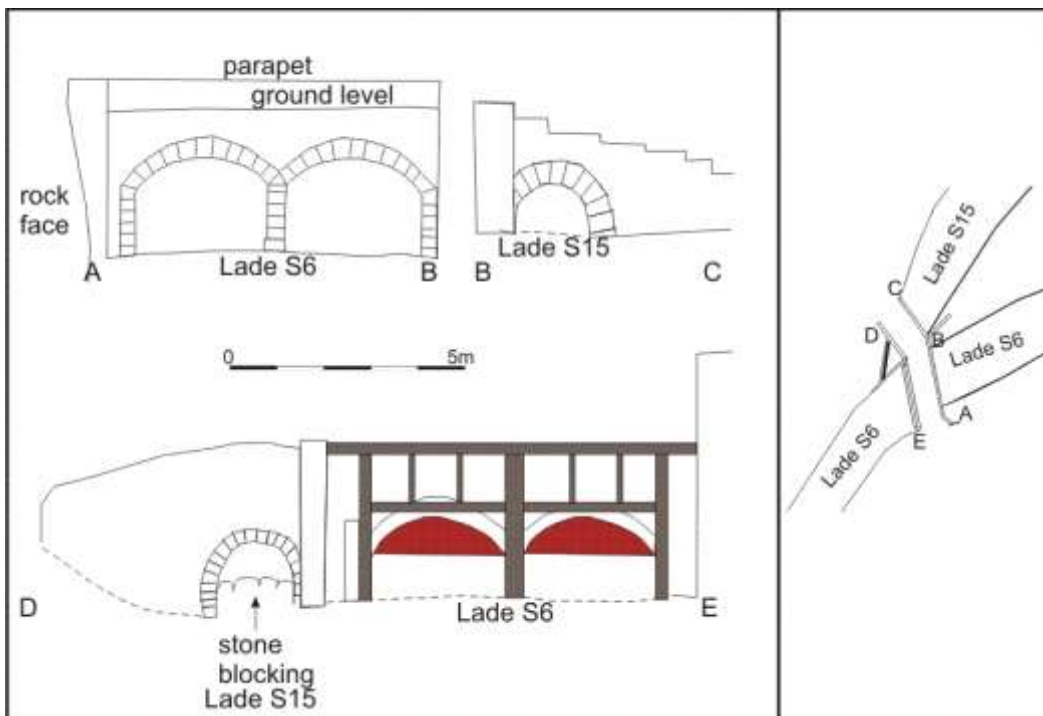

Illus 53 Elevations of S14 and plan (right) showing elevation locations



Illus 54 Sluice gate mechanisms on the west side of the bridge



Illus 55 Sluice gate structure on the west side of the bridge marked 'A Pirie & Sons 1919'.



Illus 56 Bridge S15 over Lade S6; facing SW

STRUCTURE 15

Lade S15 is an earlier lade which went out of use when the larger lade S6 and sluice gate S14 were constructed. Lade S15 was wider and shallower than the later lade; it survives to 5m wide and 0.9m deep (Illus 57-59). It has been infilled in several places and Core Path 7 has been laid on top of the lade although the edging stones can be seen on the path.



Illus 57 Lade S15 stonework under Core Path 7 with culvert (top); facing WSW



Illus 58 Lade S15 (left) and S6 (right) north of Persley Castle; facing E



Illus 59 Outflow of lade S15 at junction with river Don; facing NE



Illus 60 Earlier lade S15 blocked by north wall lade S6; facing ENE

STRUCTURE 16

Structure 16 is a small building 9.2m long and 4.6m wide (Illus 61) built into the slope of the river Don north of Woodside House (Persley) Walled Garden. It is constructed of large granite blocked with cherry cocking. There is a steep path down west of the building and steps at the east side. The building is two storeys on the north side and only one above ground level on the south side adjacent to the track.

The south wall contains a central door which would have accessed onto the first floor of the building. All walls have small arched windows (Illus 66) constructed of worked granite blocks; the interior of the arched windows on the north wall are infilled with brick which may be an original feature or a repair. Both wall overlooking the river had originally a large door in the ground floor and a large mullioned window on the first floor. Both have been infilled with brick and a loophole constructed using a wooden beam for a lintel in the brick blocking (Illus 65). The loophole is 0.48m internally and 0.35m externally. The building is roofless and the tops of the walls and windows has been lost and the interior is overgrown with vegetation.

The building is roofed on the First, Second and Third OS maps. The building is probably late 189th century in date as the pointed Gothic windows were in fashion. It may have been a gardener's cottage or summerhouse and there is anecdotal evidence that a family lived in it in the 1920s and there was a well to the west which supplied water. It would have been the first sight of Woodside Estate when travelling from the north (although it is now masked by trees (Illus 68) and this might explain its ornate architecture. The building was presumably ruinous in 1940 when surveyors were looking for buildings to form part of the defensive systems and this building in a prominent position would have been very suitable.

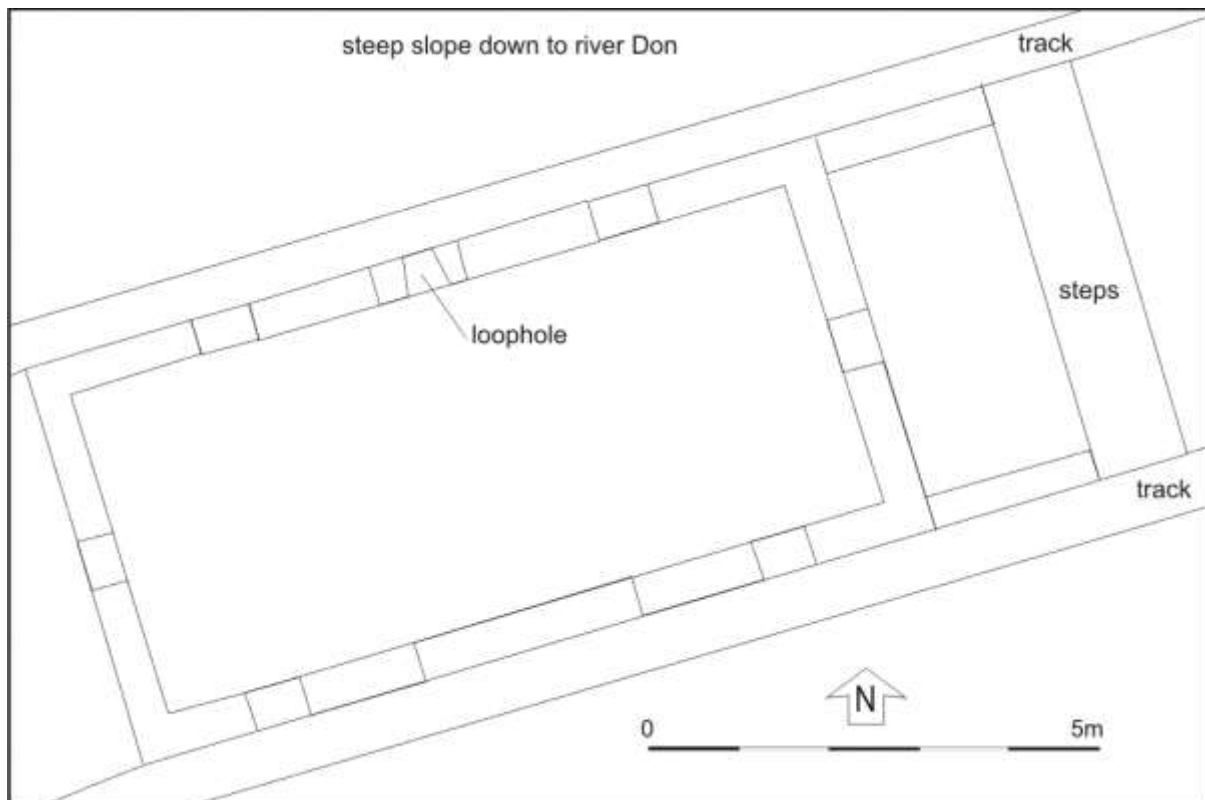

Illus 61 Plan of Structure 16

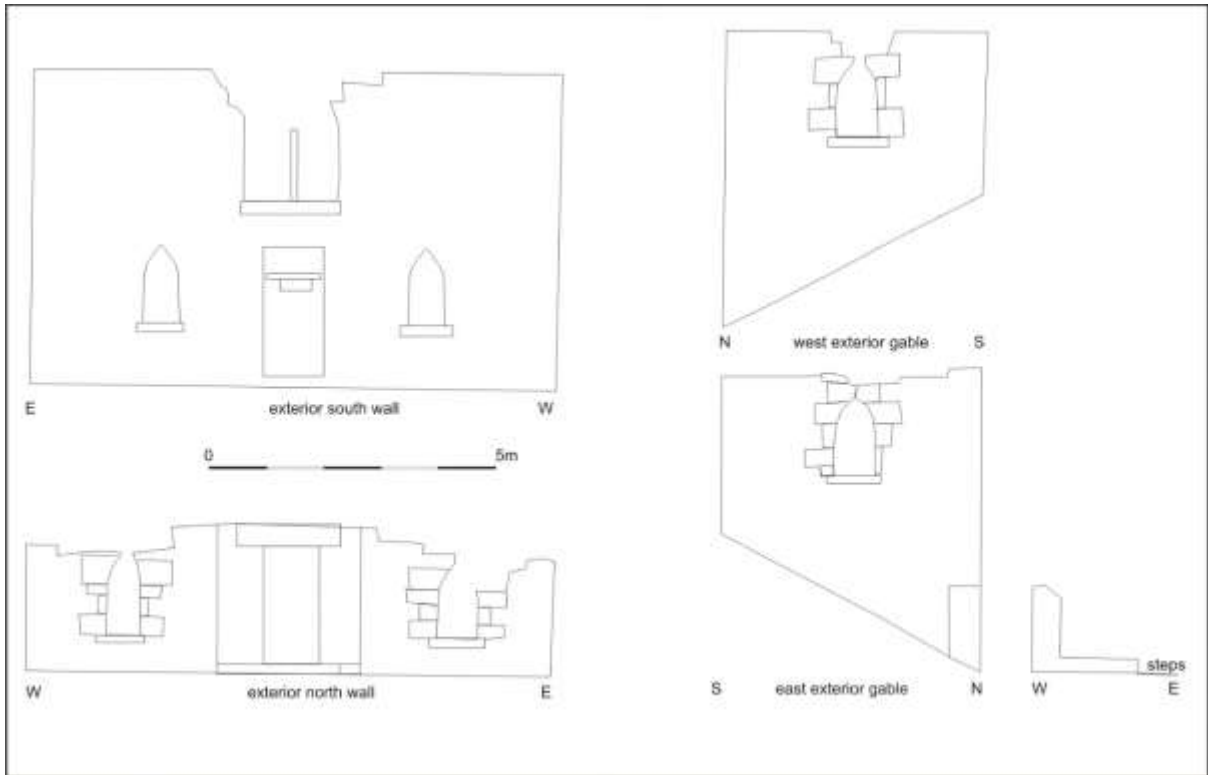

Illus 62 Structure 16 elevations of exterior walls



Illus 63 Building S16 (right), track and remains of boundary wall S20 (right); facing W



Illus 64 Structure 16 south façade; facing NW



Illus 65 Structure 16 interior of north wall showing blocked window (above) and door (below) with loophole; facing N



Illus 66 Structure 16 West wall showing arched window formed using granite blocks; facing E



Illus 67 Structure 16 east wall showing structure built into the slope and the narrow path adjacent to the slope down to the river (right); facing WSW



Illus 68 Structure 16 from north side of river Don showing elevated position above river; facing SW

STRUCTURE 17

Structure 17 is a small building 2.9m N-S and 6.0-5m E-W. It is constructed of granite rubble and is butted up against the north façade of boundary wall S21 between this wall and S20 (Illus 69). The structure is poorly preserved and overgrown and there was very limited access to the exterior of the building (Illus 71). The entrance into the building was 1.64m wide and on the south wall opposite the greenhouses north of the walled garden suggesting this structure was related to the activities in the walled garden.

The building is roofed on the First, Second and Third OS maps.

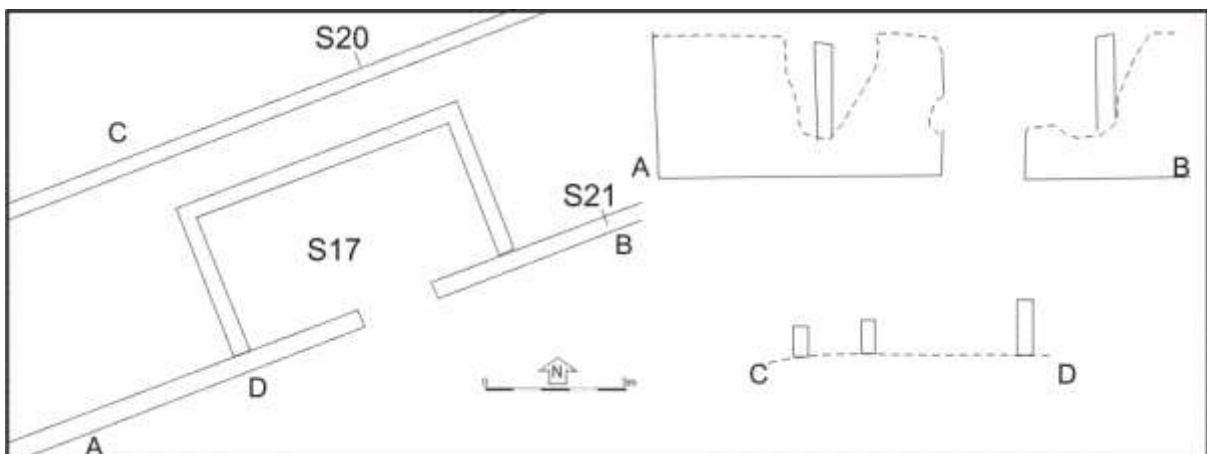

Illus 69 Structure 17 plan (left) showing entrance and relationship to walls S20 and S21 and wall elevations (right)



Illus 70 Structure 17 interior facing walled garden; facing S



Illus 71 Wall S21 with wall of S17 (left of ranging rod) showing poor condition of walls and overgrown and infilled structure with remains of entrance (left of centre)

STRUCTURE 18

Structure 18 is visible on the First, Second and Third Edition OS maps (Illus 81) and was probably one of a series of lean-to greenhouses on the exterior of the north side of S19 Woodside House (Persley) Walled Garden. The joist holes in the north face of the wall survive (Illus 72, 73) indicating that the building was 5m long and 2.2m high. Scars of other greenhouses appear on the east end of the wall. There were also freestanding and lean-to greenhouses inside the walled garden but no trace of the freestanding ones survive and the inner walls are not visible on the brick wall lining. The building is roofed on the First, Second and Third OS maps. East of this building were greenhouses on the Second and Third OS maps and a concrete scar can be seen on the wall (Illus 73).



Illus 72 Joist holes from demolished building on exterior of north wall of walled garden S19; facing S

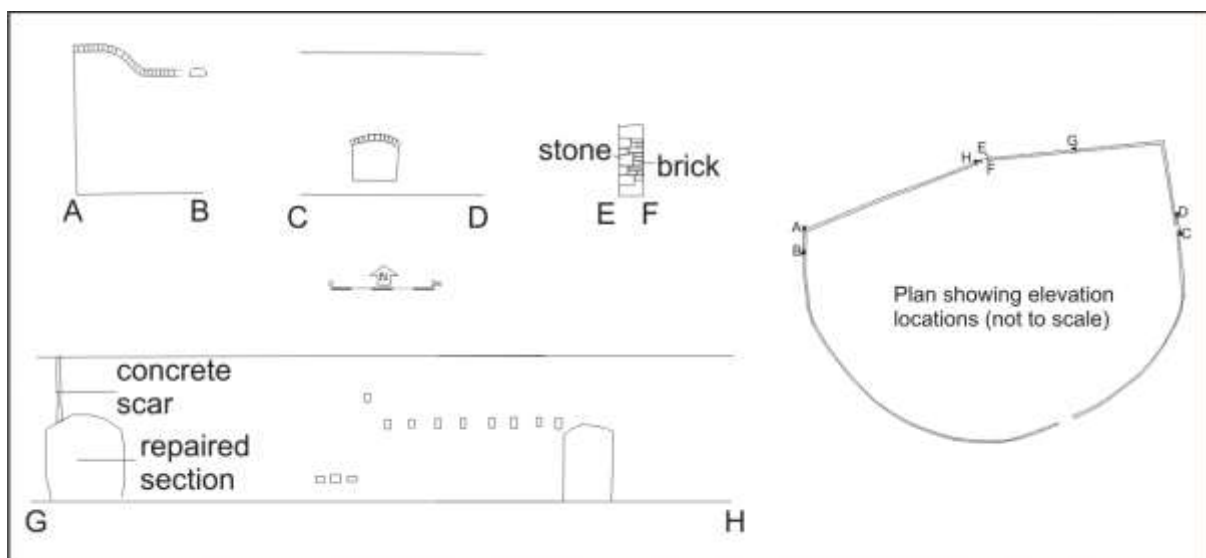

Illus 73 Elevations of walled garden with plan (not to scale) showing locations

STRUCTURE 19

Structure 19 is the walled garden of Woodside House (Persley Walled Garden). There is no date for the construction of this garden but it is included in paperwork when the estate was put on the market in 1857. It was described as 'a very superior garden, well stocked with fruit trees and berry bushes'. The estate was 76 acres which had rich soils and many shrubberies. It is now owned and managed by Aberdeen City Council having been formally dedicated on 19 July 1997 by Lord Provost Margaret Farquhar JP. The garden is 100m E-W and 70m N-S, the north wall consists of two straight walls set at an angle with a gate in the centre and a rounded south wall with a gate off centre to the SE. The walls are constructed of coursed small granite blocks (Illus 78) and the north wall and the north end of the east wall are thicker with a lining of bricks (Illus 76-77). Bricks were used to retain heat and allow the growing of soft fruits on south-facing walls. The north wall is also higher at 4m and the south wall lower at 3m crating a garden sheltered from the wind and frost; the south gate has been modernised but the shape of the earlier entrance can still be seen in the surrounding walls (Illus 80).

There was a gate in the east wall which was converted to a window (Illus 79).



Illus 74 Walled garden S19 showing thicker wall on north half of garden formed using brick on the interior; facing SW

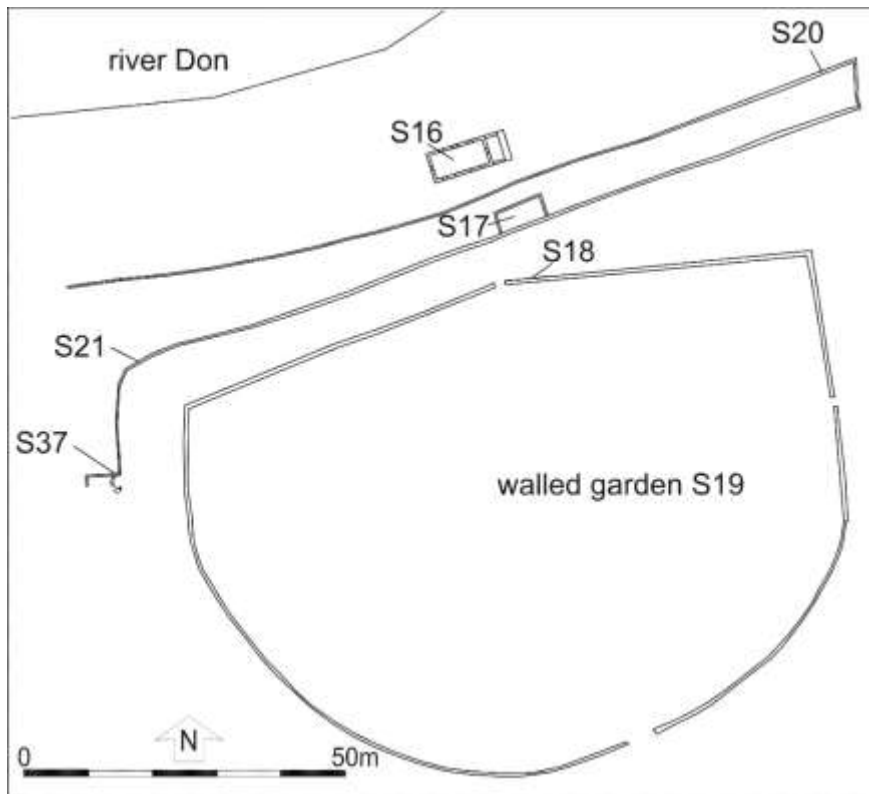

Illus 75 Plan of walled garden, Structures S16, 17 and 18



Illus 76 Gate in north wall walled garden S19 with wall S21 in background; facing N



Illus 77 Section of north wall walled garden S19 showing interior (right) lined with brick; facing E



Illus 78 Walled garden D19 showing thicker north section of east wall and thinner south section; facing W



Illus 79 Former door converted to window in centre of east wall; facing W



Illus 80 The modern entrance on the SE of the garden showing older wall line (right)

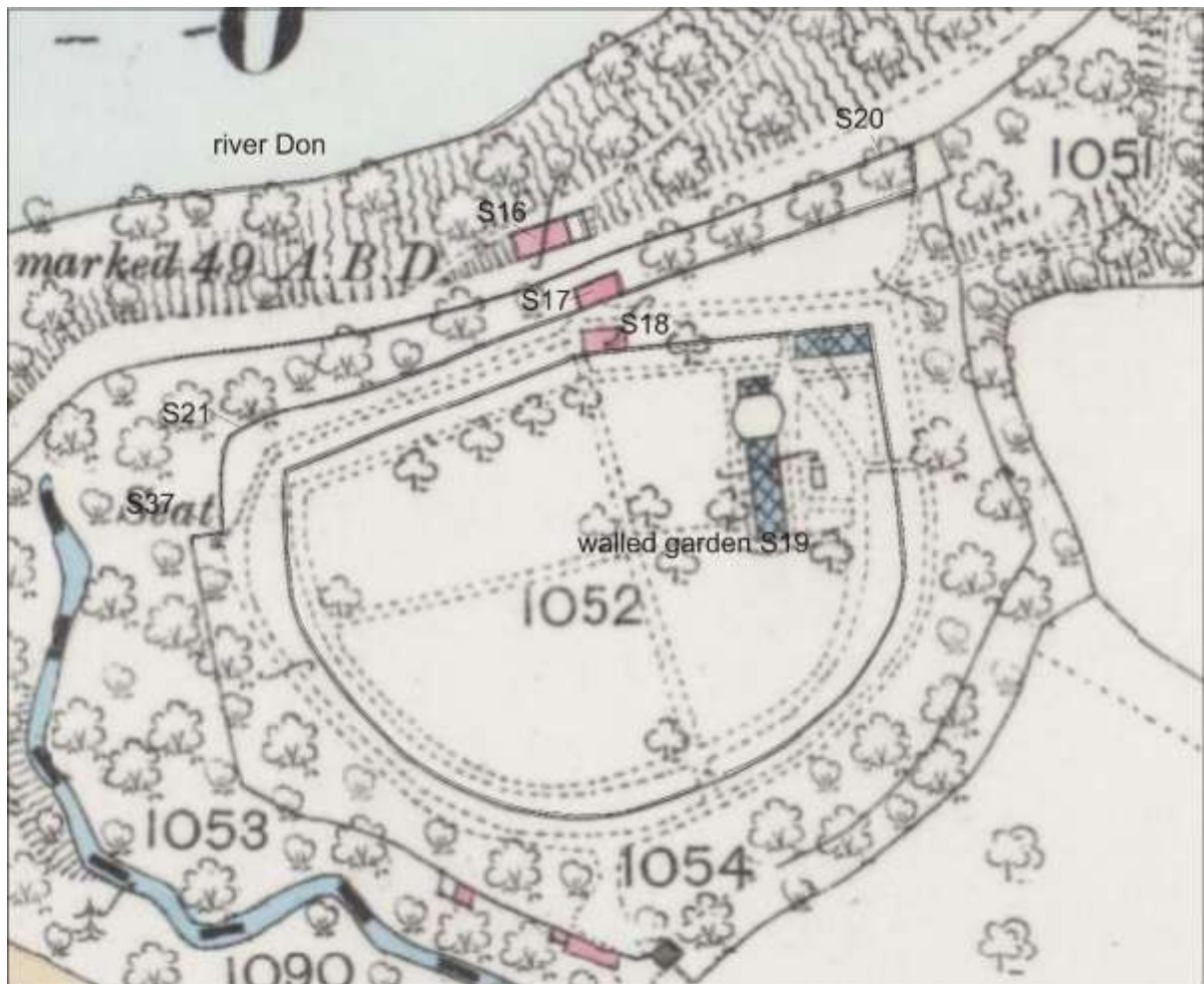

Illus 81 Walled garden and surrounding features on First Edition OS map (copyright National Library of Scotland)

STRUCTURE 20

Structure 20 is the wall along the south side of the track along the river north of the walled garden. The track took people and vehicles along the river edge to Persley Castle; Structure 16 is accessed from this track.

STRUCTURE 21

Structure 21 is the outer wall around the walled garden; there is a track around the exterior of the garden presumably mainly for the use of gardeners as the greenhouses on the north side of the walled garden were accessed from this track. Structure 17 is wedged between this wall and the northern wall Structure 20. A seat Structure 37 survives on the west end of this wall (see below). There is an entrance with gateposts at the NE where walls S20 and S21 meet forming an entrance into the area of walled garden S19.

STRUCTURE 22

Structure 22 is a poured concrete 'bridge' (Illus 82) over Lade S6 on the west side of Woodside Mills.



Illus 82 Poured concrete bridge taking footpath over remains of Lade 6; facing NNE

STRUCTURE 23

Persley Castle (Illus 83) is Listed Category B. It was built before 1797 for Gordon Baron and Co. It is two storeys made of squared granite rubble with pepper-pot turrets. It has a 3 storey crenelated tower and crenelations on the end towers. Originally dormitory for calico printing apprentices at Woodside Works.



Illus 83 South façade Persley Castle; facing N

STRUCTURE 24

Woodside House (Illus 84) is Listed category B. Parts date from 1769 and the main building 1840-50. It is 2 storey constructed of granite rubble.



Illus 84 South façade (right) of Woodside House; facing NE

STRUCTURE 25

Structure 25 (Illus 18) is the southern arm of Lade S6 which ran just north of water tank Structure 1; it has been completely infilled and is not visible on the ground.

STRUCTURE 26

Structure 26 is the remains of a concrete sluice (Illus 85) west of Persley Castle. It is a poured concrete structure with apertures and fittings for wood or metal sluice gates. It would have allowed access for extra water into lade S6. It forms part of a substantial embankment along this section of the river dividing the main lade S6 from the river which includes embankment S30.

Access to this structure was limited by the proximity of the river Don to the west and the waterlogged lade S6 to the east.



Illus 85 Remains of sluice S26 with river Don (right) and lade S6 (left); facing S



Illus 86 Sluice 26 from north bank of river Don; facing ENE

STRUCTURE 27

South of embankment S30 is sluice S27. It was the main intake for lade S6 at its southern end. The sluice is not present on the First Edition OS map and there is no detail on the Second Edition but it appears that this may have been constructed by the Second Edition as the lade has been realigned on the map. This sluice is constructed of a poured concrete embankment and platform with sluice gates at the south end. The wall with gate on the south side of the sluice would have formed the south boundary of Woodside Mill. The construction of this structure is similar in style to sluice S26 and bridge S28.

Access to this sluice is limited by its poor condition, overgrown nature and proximity of the river Don and it is not possible to access the lade at this location.



Illus 87 Sluice S27 with lade S6 (left), concrete sluice (centre), boundary wall (centre) and Structure 46 Persley Bridge (top right); facing SW



Illus 88 Sluice S27 from the north side of the river showing overgrown sluice mechanism and boundary wall; facing SE



Illus 89 S27 sluice mechanism; facing E

STRUCTURE 28

Structure 28 is a bridge is 9m long (W-E and the poured concrete piers are 2.8 x 3.6m and at least 2m deep (Illus 90, 91). The piers have been poured in shuttering and the marks can be seen on the internal faces of the piers (Illus 92). Two steel beams form the main structure of the walkway with pouted concrete in between. The steel beams are marked LANARKSHIRE STEEL CO LTD SCOTLAND 7 x 4' with 'BRITISH STEEL' in a rectangular logo (Illus 93) indicating 7 x 5 inches in size. The Lanarkshire Steel Co Ltd opened 1890 and closed in 1978. This structure was demolished in early 2014 to allow for construction of a wider bridge on Core Path 7.

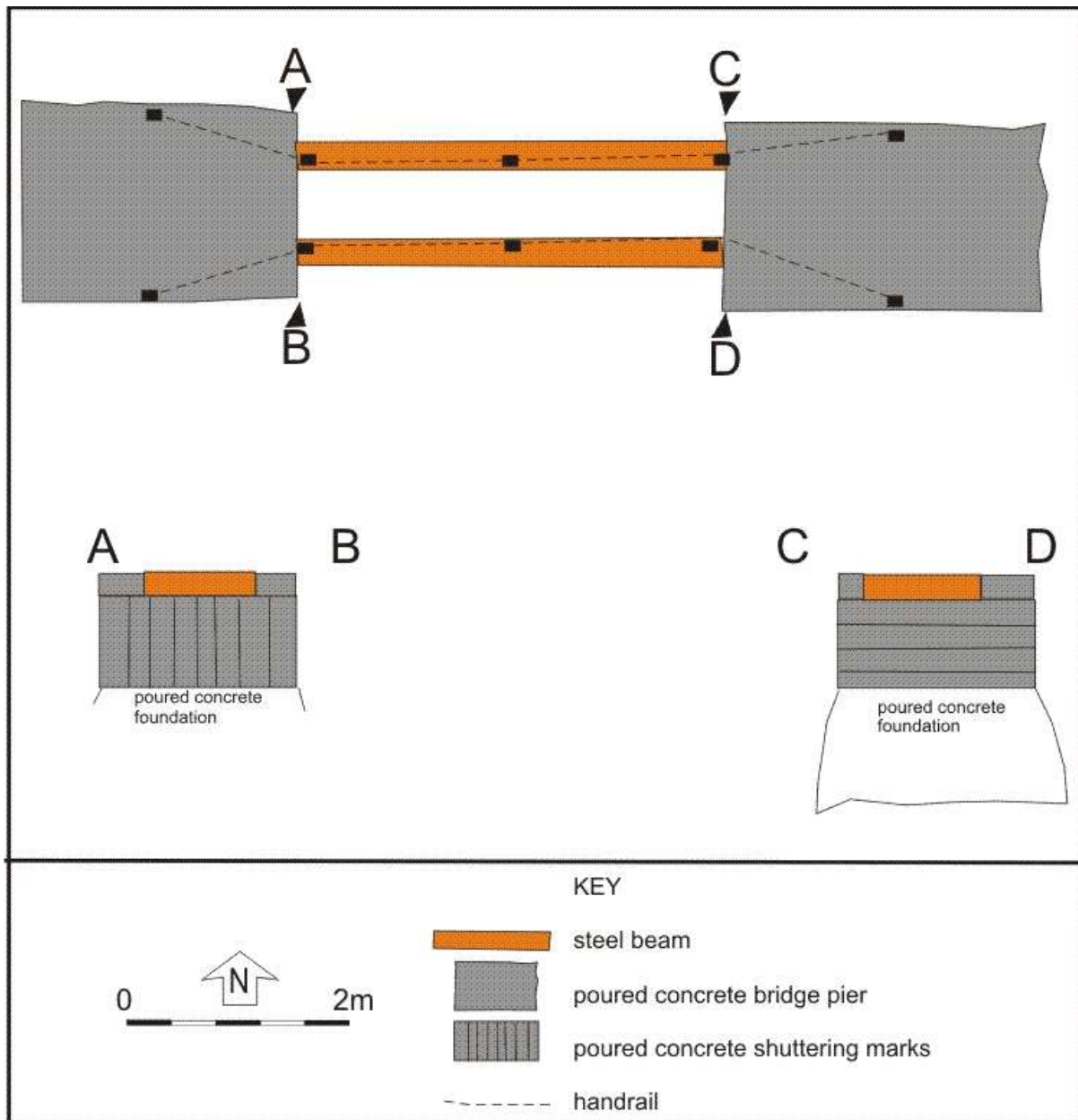

Illus 90 Plan and elevation of poured concrete bridge S28



Illus 91 The bridge S28 facing west



Illus 92 Bridge S20 poured concrete pier on the west side of the bridge



Illus 93 Bridge S28 with steel beam marked 'LANARKSHIRE STEEL CO LTD SCOTLAND 7 x 4' with 'BRITISH STEEL'

STRUCTURE 29

This weir across the river Don was recorded photographically only.

STRUCTURE 30

Between Sluices S27 and S27 is a substantial stone embankment dividing lade S6 from the river Don. A section has a rough cobbled pathway (Illus 94) which forms part of the track along the river.



Illus 94 Stone embankment S30 with river Don (left), Lade S6 (right) and Persley Castle (top); facing NE.

STRUCTURE 31

Structure 31 is a weir across the river Don which was recorded photographically only



Illus 95 Weir S31 with Persley Bridge (top left); facing SW

STRUCTURE 32

Structure 32 is an outflow of lades S6 and S8 at the north of the Woodside Mill complex. It survives now as a shallow channel with rough stone wall visible on the south side (Illus 97).



Illus 96 Remains of channel S32 outflow into river Don (top); facing ENE



Illus 97 Remains of stone wall on south side of channel S32 outflow into river Don; facing S

STRUCTURE 33

Structure 33 is a culvert and bridge over lade S13 with decorative gateposts on the west side (Illus 98). The culvert is formed by a brick arch on a stone foundation (Illus 99, 45).



Illus 98 North face of culvert and bridge S33 for lade S13; facing SSW



Illus 99 South face and east pier of culvert S33 with bridge above showing brick vaulting on stone foundation; facing E



Illus 100 Culvert S10 (right) and S33 (left) with S34 between from north bank of river Don; facing SW

STRUCTURE 34

Structure 34 is a stone embankment on the south bank of the river Don between lade outflows S10 and S33 (Illus 100, 101). It was not possible to access this due to its poor condition and proximity to the river.



Illus 101 Stone embankment S34 (centre) with culvert S10 (right)

STRUCTURE 35

Structure 35 is a stone embankment blocking the outflow of lades S6 and S8 (Illus 102); the lades and outflow have been completely infilled and are not visible on the ground. It is constructed of granite rubble and is not easily accessible but can be seen clearly from the north bank of the river Don (Illus 103).

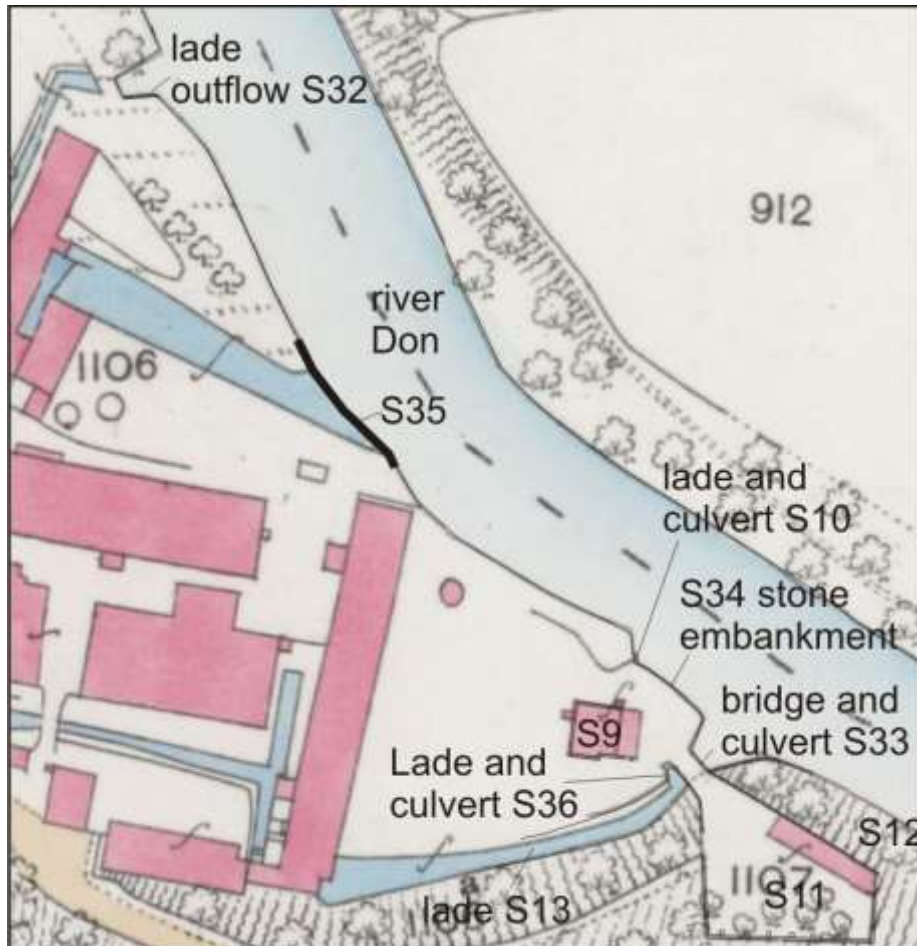

Illus 102 Plan showing S35 (centre) on First Edition OS map showing infilled lade to the west



Illus 103 Stone and concrete embankment at the junction of outflow of Lades 6 and 8 to river Don; from north bank of the Don; facing SW

STRUCTURE 36

Structure 36 is the culvert through which an unidentified lade entered lade S13 and under culvert S33 and in to the river Don (Illus 102). The small culvert is stone vaulted (Illus 104) 1.8m diameter and set on a stone foundation (Illus 105).



Illus 104 Culvert S36 showing stone vaulting with bridge and culvert S33 (right); facing NW



Illus 105 Culvert S36 showing stone vaulting on stone foundation; facing NW

STRUCTURE 37

Structure 37 is a vaulted domed structure at the SW end of wall S21. It is almost completely obscured by a large tree growing on the top of the structure and it has also been burrowed by animals. The structure was originally semi-circular in shape with its opening to the east. It is constructed of heavily lime mortared granite fieldstones (Illus 108) with remains of a dressed stone opening (Illus 107). The maximum surviving height is c 2m and 2.7m internal diameter. It is marked as a 'seat' on the First (but not subsequent) OS Editions and would have provided shelter and a good view of the tree covered walkway around the west side of the walled garden.

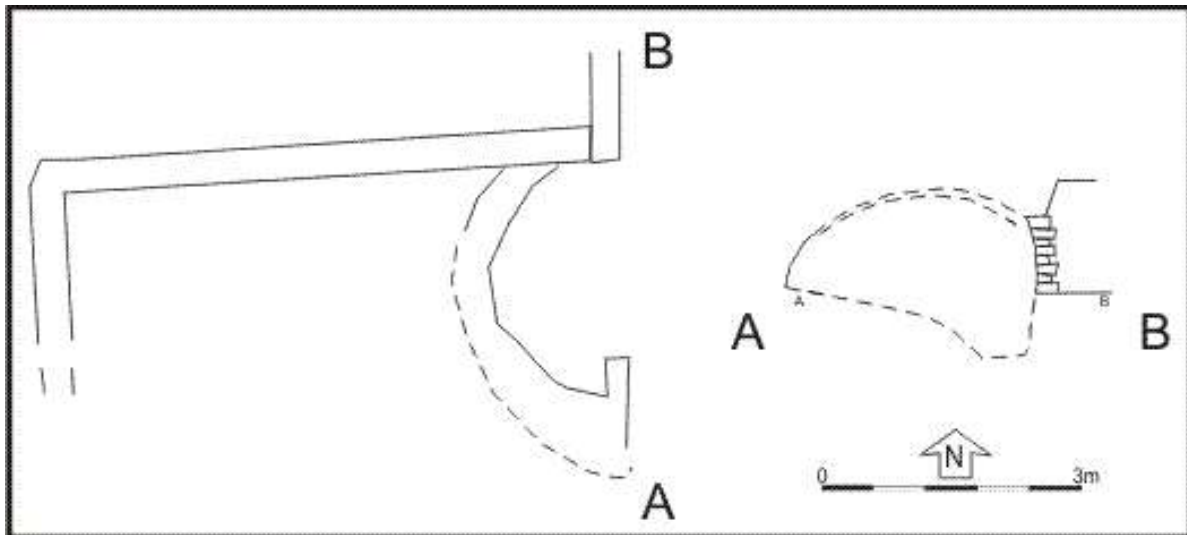

Illus 106 Plan (left) and elevation (right) of 'seat' S37



Illus 107 Entrance to Structure 37; facing W



Illus 108 Rear (west side) of structure 37 showing damage due to tree virtually obscuring the feature

STRUCTURE 38

Structure 38 is a track or hollow way through mound S40 (Illus 109) which appears on the First, Second and Third Editions of the OS maps.



Illus 109 Structure 38 hollow way through mound S40; facing S

STRUCTURE 39

This is a loose stone revetment (Illus 110) on the south facing side of mound S40. It is modern in origin and is in an area where there has been much dumping of rubble.



Illus 110 Stone revetment S39 on south side of mound S40; facing NE

STRUCTURE 40

Mound S40 (Illus 111) appears on the First, Second and Third Edition OS maps and is probably of natural origin. Track or hollow way S38 cuts through the mound.



Illus 111 Mound, probably natural with stone and rubble dumped on south side; facing NE

STRUCTURE 41

Structure 41 is a World War 2 pillbox situated in the NE corner of a mobile home park overlooking the river Don and Persley bridge. It is hexagonal in plan, elongated along its E to W axis, and measures 4.25m from E to W by 3.8m N-S with 0.4m thick walls and blocked embrasures on each wall except the south. On the south side there is an entrance with a modern wooden door, to the W of which is a small loop-hole. Scarring on the wall on either side of the entrance suggests that a blast-wall has been removed. In the remaining five sides the original loop-holes have been blocked. Within the interior there is a central concrete anti-ricochet wall (although this was inaccessible during this survey). Pillboxes of this design fall into the type-22 category (Brown *et al* 1996, 82-84).



Illus 112 Pillbox Structure 41 north-facing elevation with blocked embrasure



Illus 113 Pillbox Structure 41 south facing external wall showing central door, small aperture and 30cm thick concrete foundation

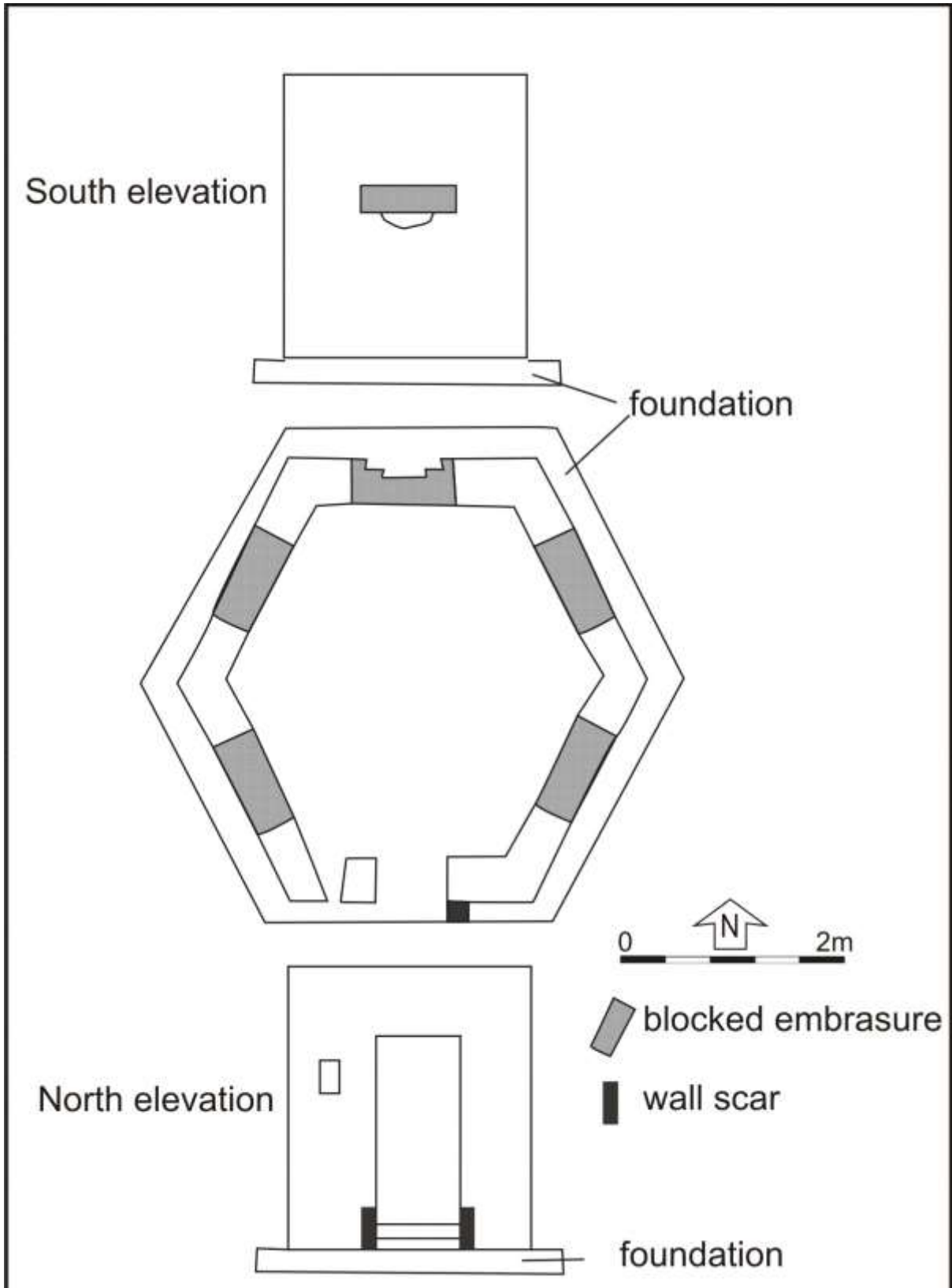

Illus 114 Pillbox Structure 41 plan of pillbox and elevations

STRUCTURE 42

This enclosure was located north of Structure 7 on the First, Second and Third Edition OS maps; there is mounding of soil, building materials and undergrowth but no evidence of this enclosure was identified during this survey.

STRUCTURE 43

Lade outflow taking water from lades S6 and S8 to the river Don. This appears on the First, Second and Third Edition OS maps but there is no trace of this lade which has been infilled.

STRUCTURE 44

Two walls on the outside of enclosure S 11 can only be seen from the interior where the walls of the enclosure has collapsed (Illus 112). These cannot be seen from the exterior of the enclosure and it is uncertain what they are part of.



Illus 115 Two narrow brick walls on exterior of west wall of enclosure S11; facing W

STRUCTURE 45

On the west bank of the Scatter Burn is March Stone 49 previously thought lost. The stone is Listed B and there is a modern replacement on the east side of Persley Bridge (NJ90NW 0898).



Illus 116 ABD 49 March Stone (Copyright Aberer Eladany; photographed 2013)

STRUCTURE 46

Persley Road Bridge, Listed category B, carries the A92 over the river Don. It was built by P.M. Barnett, with James Leith, as contractor in 1891. It consists of 3 segmental river arches and 2 land arches (Hume 1977, 111).



Illus 117 Persley Bridge; facing W

STRUCTURE 47

Grandholm Foot Bridge forms the eastern boundary of this survey area. The Grandholm Bridge is a private bridge, constructed for the Crombie Mills in the 1920s. Access to the bridge, other than for pedestrians and bicycles, is now controlled by an electronically activated barrier, passes for which are made available to residents of the housing development constructed on the site of the mills in 2004.



Illus 118 Grandholm foot bridge; facing E



Illus 119 Roy Military Survey of Scotland 1747-55 showing 'copper mill' but no Gordon's Mill or Woodside (copyright National Library of Scotland)



Illus 120 Robert Gordon c1636-52 showing Gordons Mill (copyright National Library of Scotland)



Illus 121 Blaeu 1654 showing Gordon's Mills to the east and The Cruvis to the west (copyright National Library of Scotland)

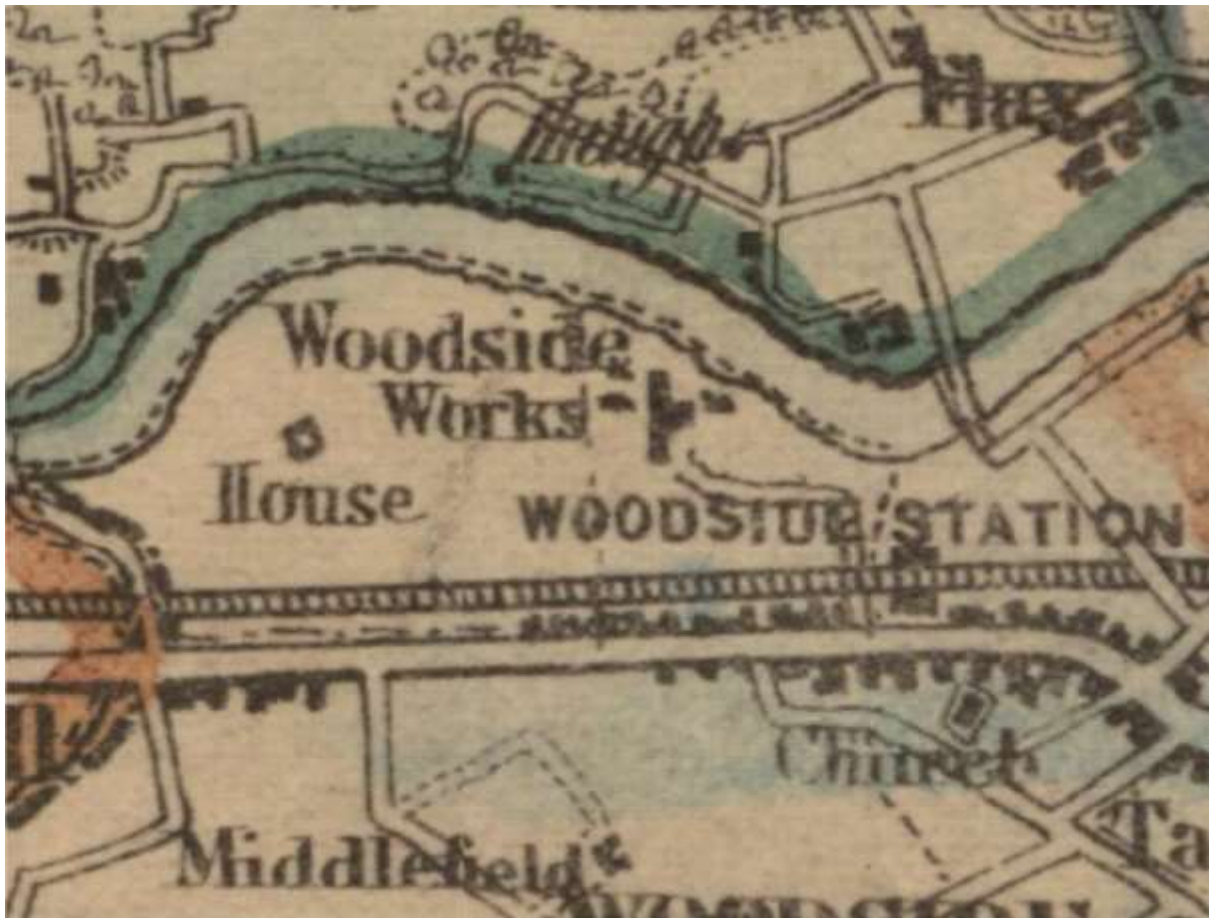

Illus 122 Gibb 1858 showing Woodside Works and [Woodside] House (copyright National Library of Scotland)



Illus 123 1973 aerial photograph showing sand and gravel workings (now Hutcheon Low Court) to the east of the walled garden. Date: 10 August 1973 Location: Persley, Old Machar, ABERDEENSHIRE, SCOTLAND Coordinates (lat, lon): 57.184841, -2.159891 UNI: NCAP-000-000-075-141.

REFERENCES

Brown, I, Burridge, D, Clarke, D, Guy, J, Hellis, J, Lowry, B, Ruckley, N and Thomas, R
1996 20th century defences in Britain: An Introductory Guide. Council for British
Archaeology. Practical Handbooks in Archaeology No 12 (revised edition).